

(DE) (BE)

Teleskop-Insektenschutz für Türen

(FR) (BE)

Moustiquaire télescopique pour portes

(NL) (BE)

Telescopische insectenhor voor deuren

(ES)

Mosquitera telescópica para puertas

(CZ)

Hliníkové sítě proti hmyzu na dveře

(PL)

Teleskopická síť proti hmyzu pro dveře

(SL)

Teleskopska zaščita pred insekti za vrata

(HU)

Teleszkópos rovarháló ajtókhöz

(IT)

Zanzariera telescopica per porte

(PT)

Proteção telescópica contra insetos para portas



Montageanleitung

Instructions de montage

Montagehandleiding

Instrucciones de montaje

Návod k montáži

Instrukcje montażu

Navodila za sestavljanje

Összeszerelési útmutató

Istruzioni di montaggio

Instruções de montagem

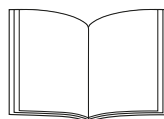



Bitte vor Montage sorgfältig alle Punkte lesen! Anleitung aufbewahren und bei Weitergabe des Produktes mit aushändigen!

Bestimmungsgemäßer Gebrauch

Das Insektenschutzprodukt darf nur für den bestimmungsgemäßen nicht gewerblichen Gebrauch (Montage zum Schutz vor Eindringen von Insekten im privaten Bereich) verwendet werden. Bei missbräuchlicher Nutzung kann es zu erheblichen Gefährdungen kommen. Zusätzliche Belastungen dieses Produktes durch angehängte Gegenstände oder Bedienung über die mechanischen Begrenzungen hinaus können zur Beschädigung des Produktes führen und sind daher nicht zulässig. Für hieraus resultierende Schäden haftet der Hersteller nicht.

Sicherheitshinweise

Folienbeutel und Kleinteile von Kindern fernhalten!
ERSTICKUNGSGEFAHR!

Haftung

Bei Nichtbeachtung der in dieser Anleitung angegebenen Hinweise und Informationen, bei nicht bestimmungsgemäßem Gebrauch oder bei Einsatz außerhalb des vorgesehenen Verwendungszweckes, lehnt der Hersteller die Gewährleistung für Schäden am Produkt ab. Die Haftung für Folgeschäden an Elementen aller Art oder Personen ist ausgeschlossen.

Reinigung

Verwenden Sie zur Reinigung nur ein feuchtes Tuch mit mildem Reinigungsmittel. Das Gewebe können Sie mit einem Staubsauger (mit Bürstenaufsatz) oder Handbesen von Staub befreien.

Entsorgung

Denken Sie an den Umweltschutz. Zur Entsorgung von Verpackungsmaterialien und Altgeräten gibt es ein öffentliches Rücknahmesystem. Auskünfte über Sammelstellen und aktuelle Bestimmungen erhalten Sie bei Ihrer Stadt- oder Gemeindeverwaltung.



- Verwenden Sie benötigtes Werkzeug umsichtig um Verletzungen zu vermeiden. Tragen Sie Schutzausrüstung (z. B. Schutzbrille).
- Stellen Sie vor der Verwendung sicher, dass alle Teile unbeschädigt und vorhanden sind. Beginnen Sie keine Montage bei Fehlteilen oder beschädigten Teilen.

Gewährleistung

Es gilt die gesetzliche Gewährleistungspflicht.
Von der Gewährleistung ausgenommen:

- Unsachgemäße Benutzung
- Unsachgemäße Montage
- Schäden durch zu aggressive Reinigung
- Schäden durch nicht originale Ersatzteile
- Schäden durch Verletzung der Sorgfaltspflicht
- Verschleißteile
- Nicht vorgesehene Verwendung

Service

hecht international GmbH | Im Herrmannshof 10 | 91595 Burgoberbach | GERMANY | +49 (0)9805-93331981
www.hecht-international.com/service

Symbolerklärung

Nachfolgend gelistete Warnsymbole werden in dieser Montageanleitung verwendet.



Klemmgefahr!

Bei der Montage oder Justagearbeiten besteht die Gefahr von Klemm-/Quetschverletzungen!



Schnittgefahr!

Bei der Montage besteht die Gefahr von Schnittverletzungen!



Hinweis / Aufmerksamkeit

Bei der Montage ist besondere Aufmerksamkeit gefordert, Ansichten zu beachten oder eine Handlung auszuführen!



Achtung!

Mögliche Sachbeschädigungen oder anderweitige durch Unachtsamkeit entstehende Verletzungen/Gefahren!



Wichtige Information!

Wichtige Information für Montage und Funktion!



Absturzgefahr!

Nicht gegen das Produkt lehnen.
Auf eigene Sicherheit achten.



Warnung!

Gefährdung durch magnetische Felder. Personen mit Herzschrittmacher dürfen sich keinen magnetischen Feldern aussetzen.
Setzen Sie keine Datenträger (z. B. Kreditkarten) oder elektronische Geräte (z. B. Handy) den magnetischen Feldern aus.

Werkzeug

Gereedschap - Outils - Herramienta - Nástroj - Narzędzie - Orodje - Szerszám - Strumento - Ferramenta - Værktøj

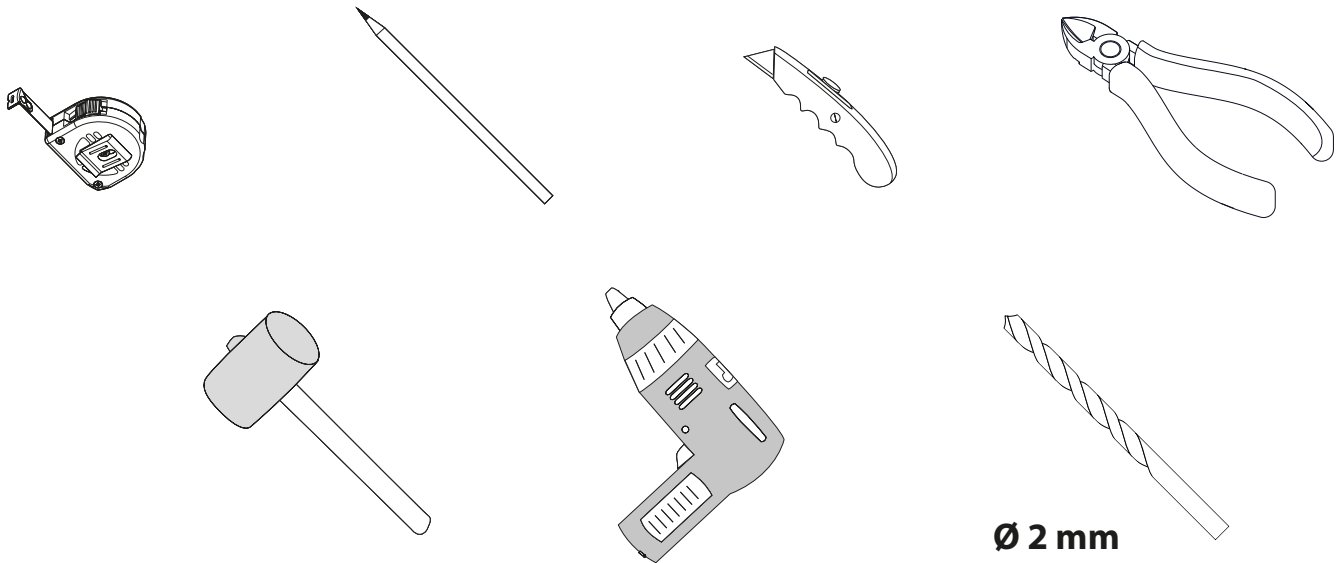

Montagehinweis

Montage-instructies - Instructions de montage - Instrucciones de montaje - Pokyny k montáži - Instrukcje montażu - Navodila za montažo - Szerelési útmutató - Istruzioni per il montaggio - Instruções de montagem - Instruktioner til montering

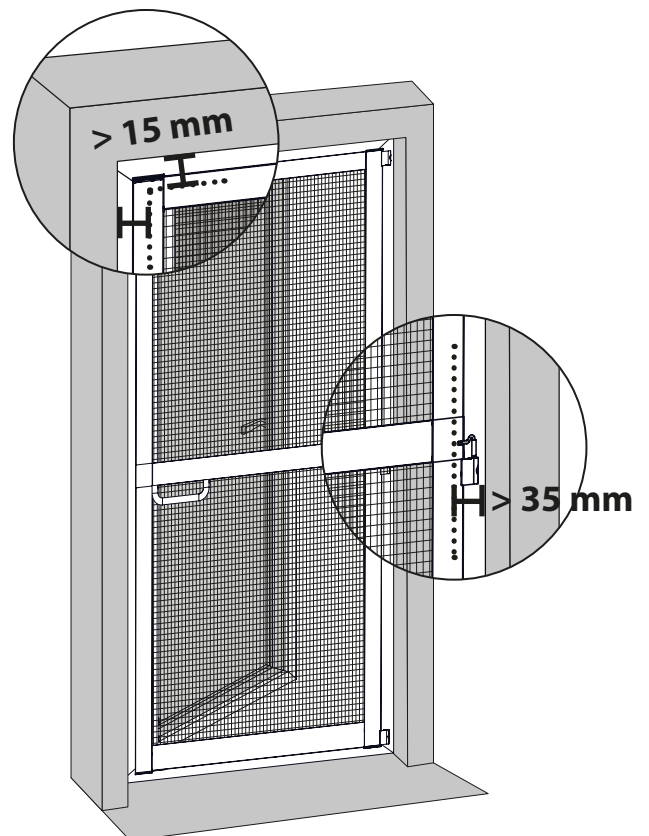
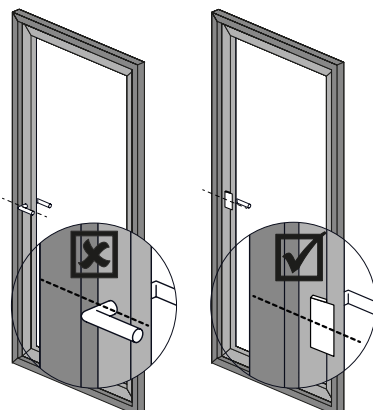
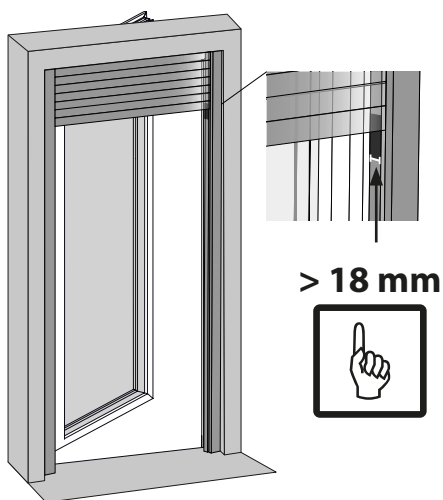

Lieferumfang

Leveringsomvang - Contenu de l'emballage - Volumen de suministro - Rozsah dodávky - Zakres dostawy - Obseg dobave - A szállítás terjedelme - Ambito di consegna - Âmbito da entrega - Leveringsomfang

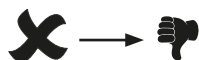
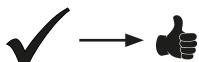
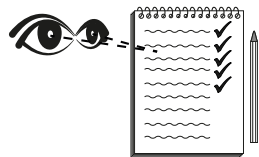

www.hecht-international.com/service

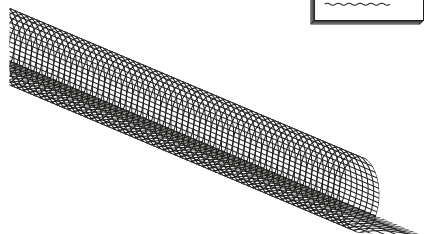

1x
A S-0097

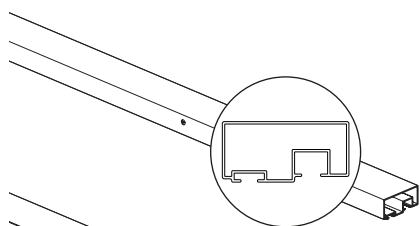

1x
B 01419-0001-01
1150 mm

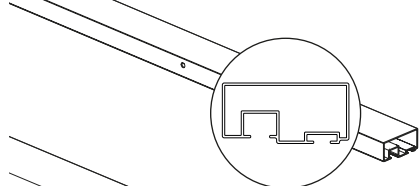

1x
C 01419-0001-02
1150 mm

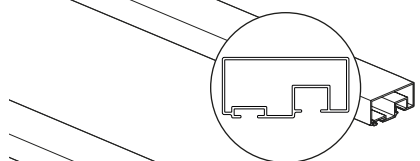

2x
D 01419-0001-00
500 mm

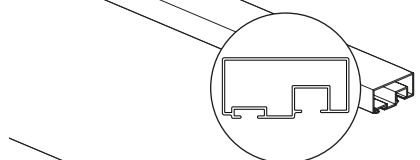

4x
E 01419-0001-00
325 mm

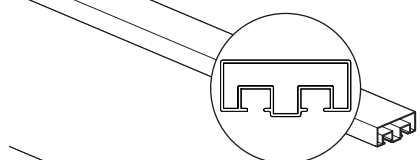

1x
F 01419-0004
633 mm

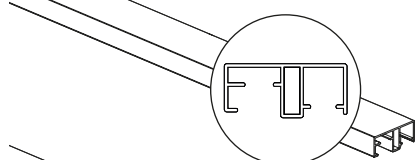

2x
G 01419-0002
500 mm

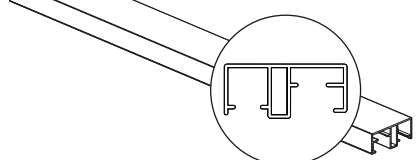

2x
H 01419-0002
500 mm

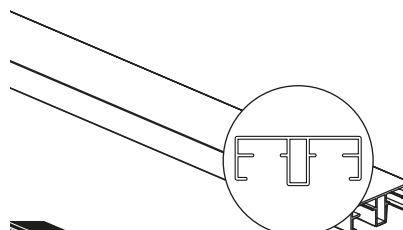

2x
I 01419-0003-00
318 mm

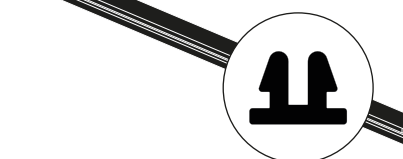

8x
J S-0017
2x 1150 mm
2x 910 mm
2x 945 mm
2x 970 mm

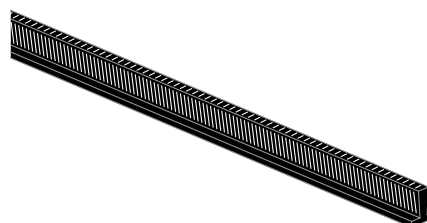

1x
K S-0002

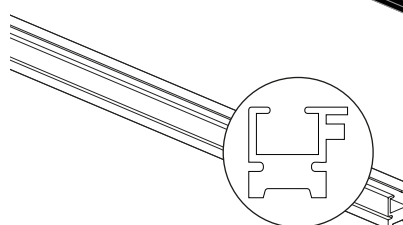

8x
L 01419-0012
2x 396 mm
2x 294 mm
4x 104 mm

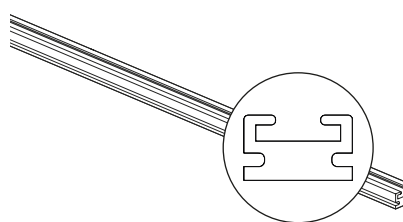

4x
M 01419-0013
2x 396 mm
2x 294 mm

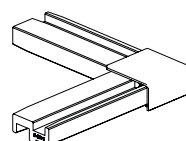

2x
N 01419-0005

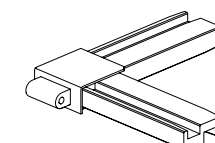

1x
O 01419-0021

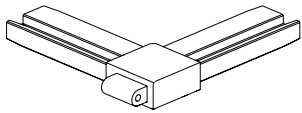

1x

P 01419-0022

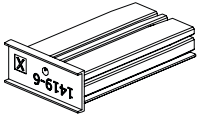

1x

Q 01419-0006

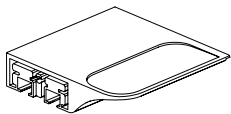

1x

R 01419-0007

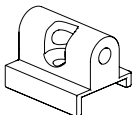

1x

S 01419-0010

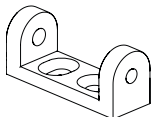

3x

T 01419-0018

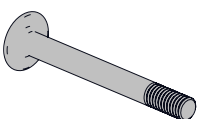

2x

U 01419-0025

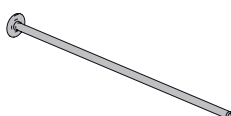

1x

V 01419-0026

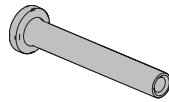

2x

W 01419-0028

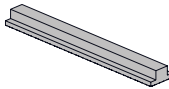

3x

X 01419-0019



3x

Y 00014-0044

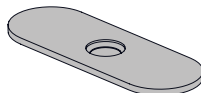

3x

Z 00014-0027



3x

A1 00014-0045

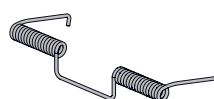

1x

B1 01419-0027

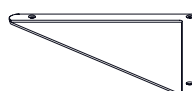

4x

C1 01419-0029

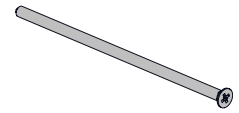

1x

D1 S-0132

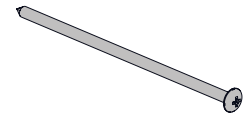

1x

E1 S-0131

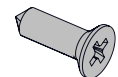

9x

F1 N-0002

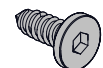

12x

G1 S-0135

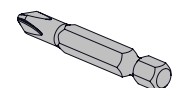

1x

H1 W-0002

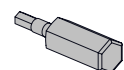

1x

I1 W-0031

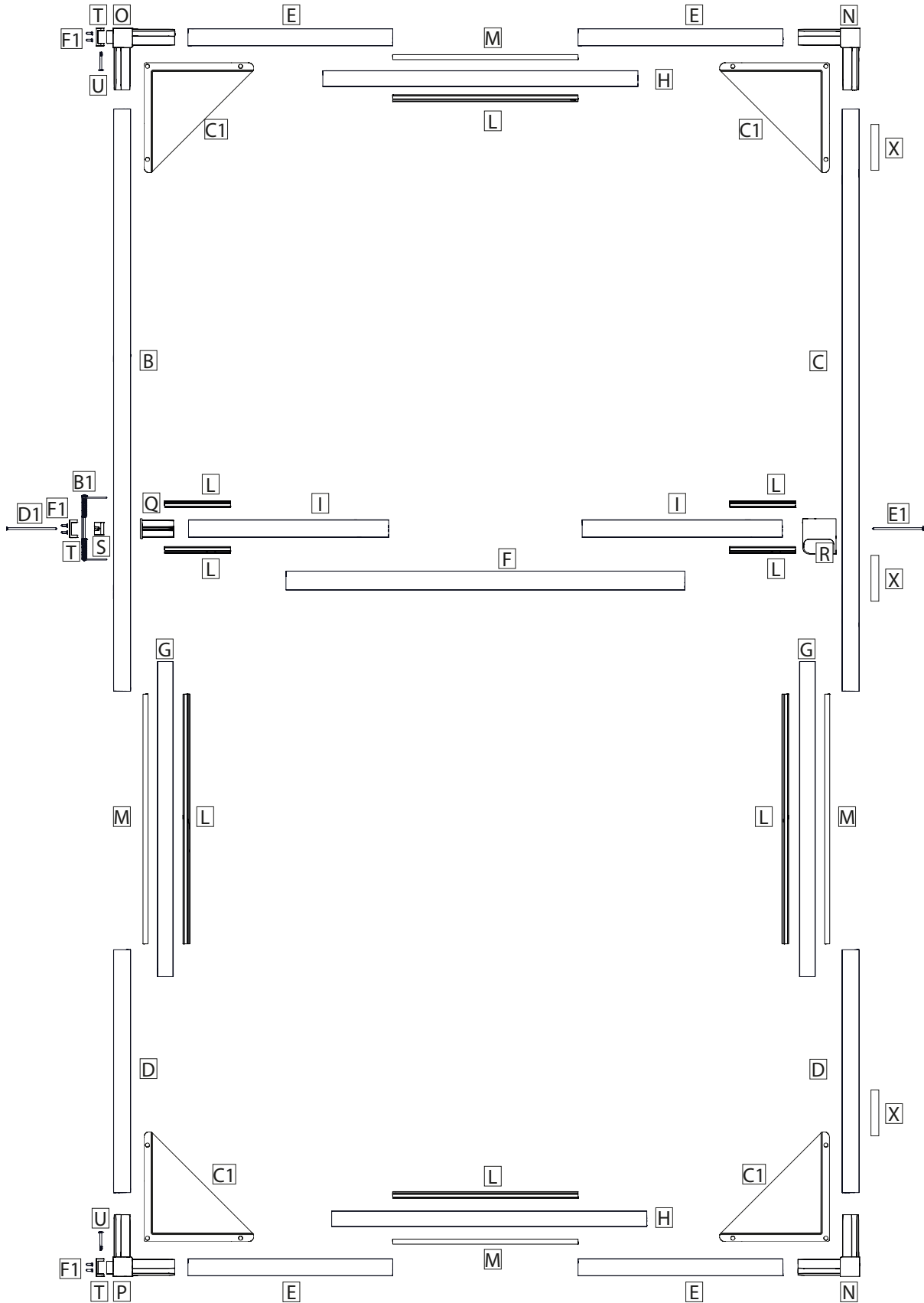
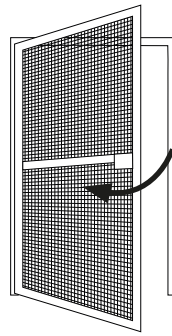

Montage

Montage - Montage - Montaje - Montáž - Montaž - Montaža - Összeszerelés - Montaggio - Montagem - Montering

1



MAX
X = 950 mm
Y = 2070 mm

MIN
X = 660 mm
Y = 1670 mm

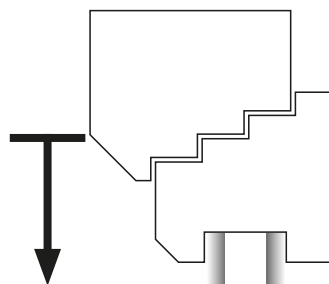
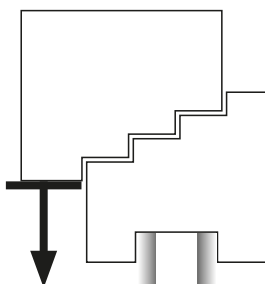
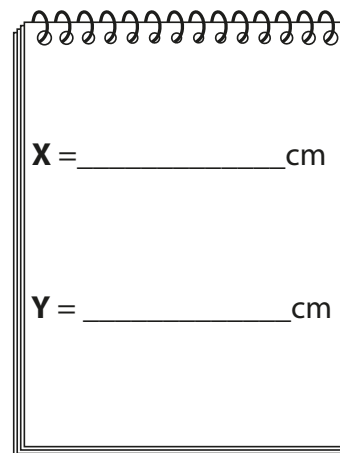
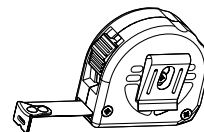
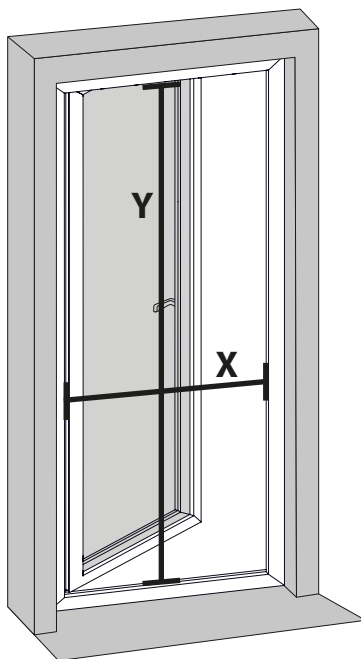

MAX

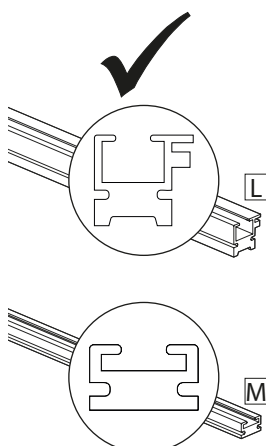
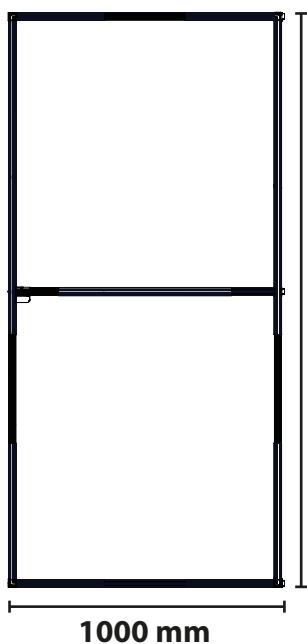

MIN

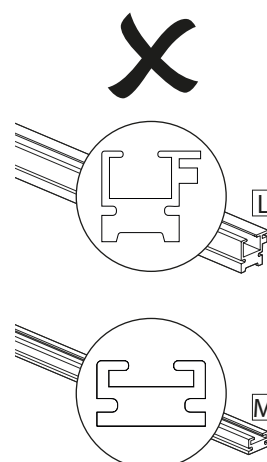
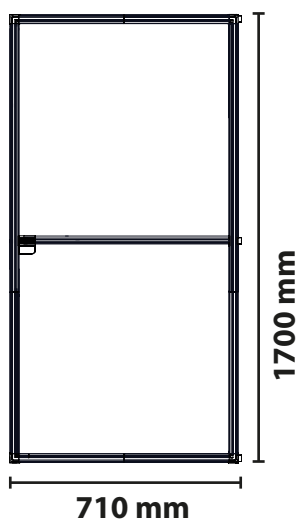

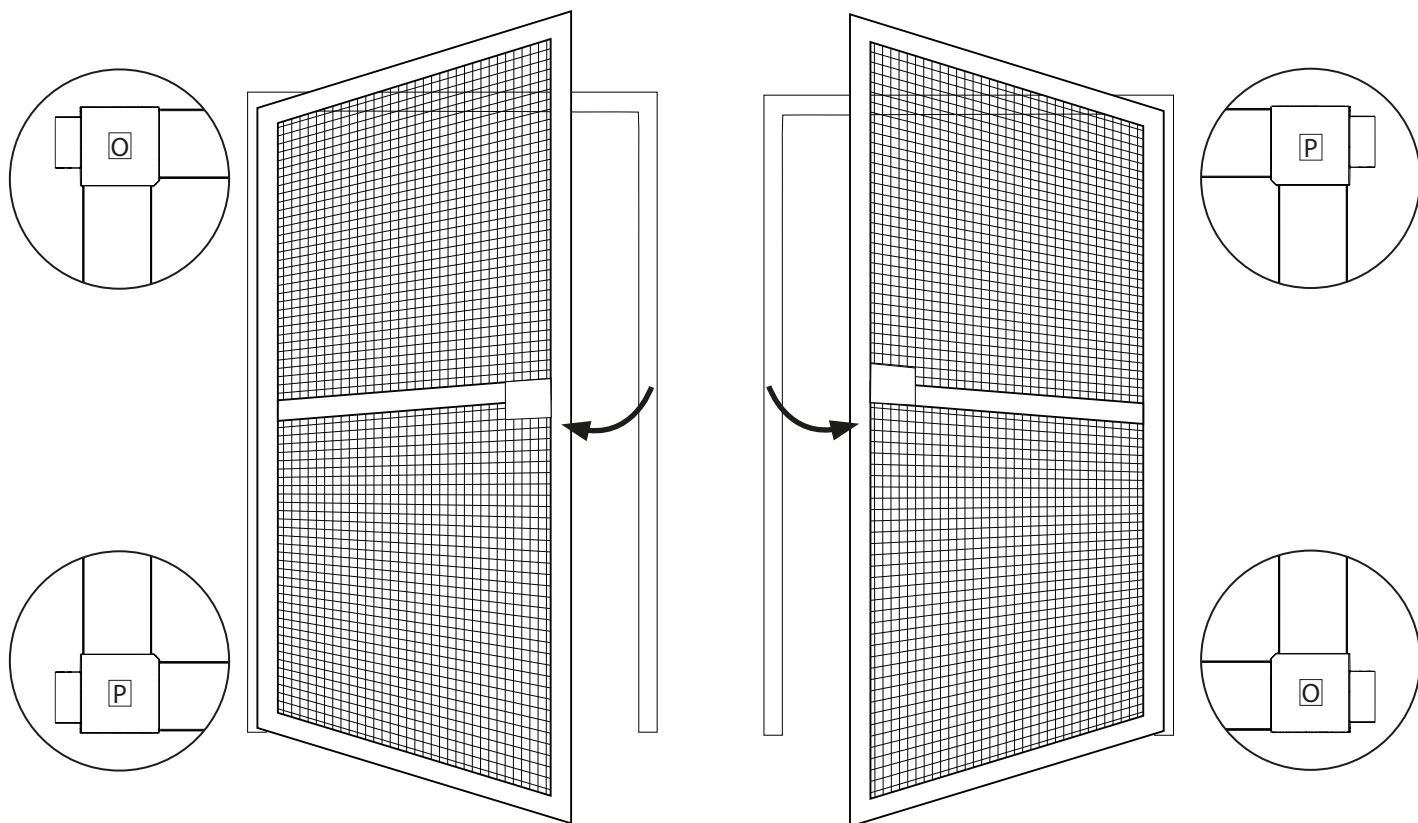

2

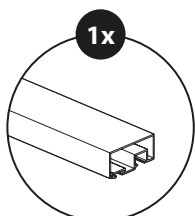

B 01419-0001-01
1150 mm

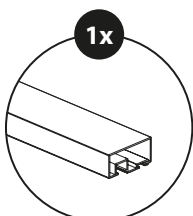

C 01419-0001-02
1150 mm

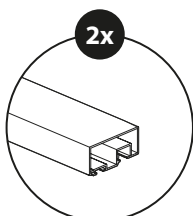

E 01419-0001-00
325 mm

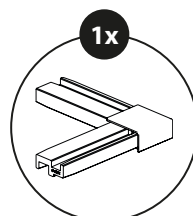

N 01419-0005

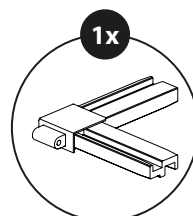

O 01419-0021

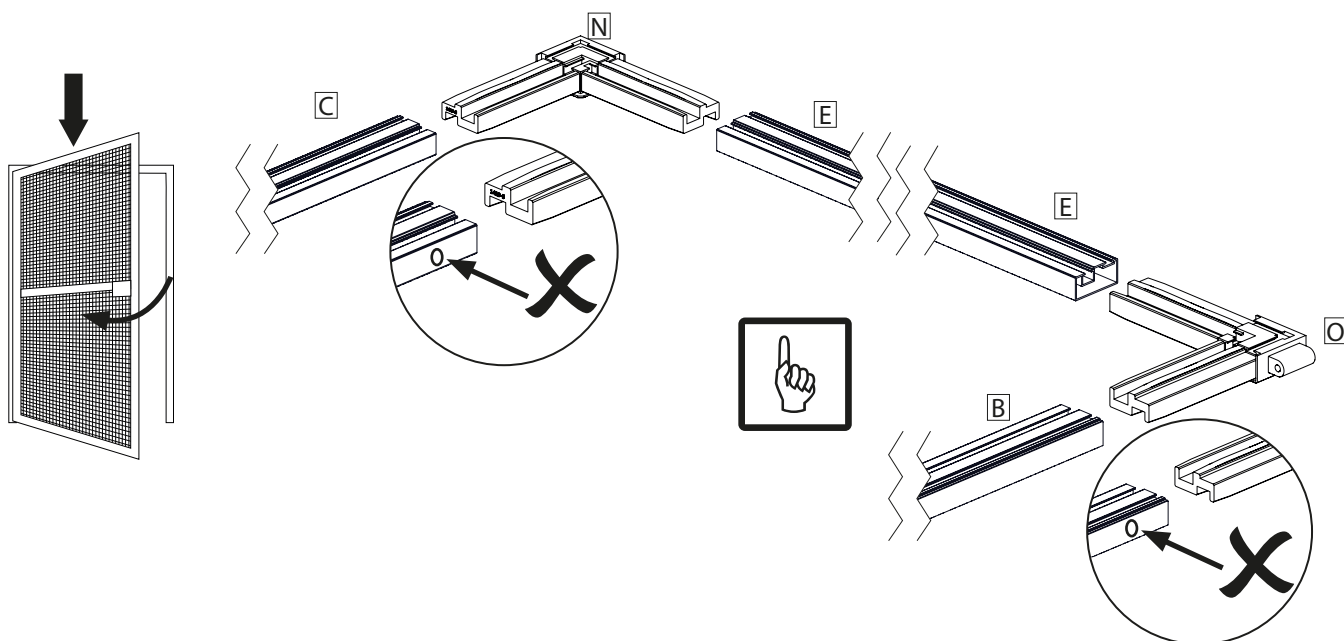

3

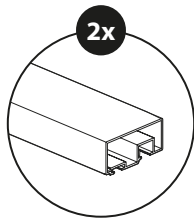

2x

D 01419-0001-00
500 mm

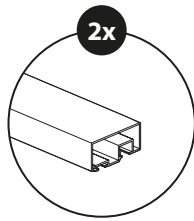

2x

E 01419-0001-00
325 mm

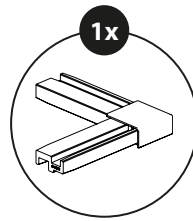

1x

N 01419-0005

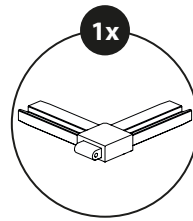

1x

P 01419-0022

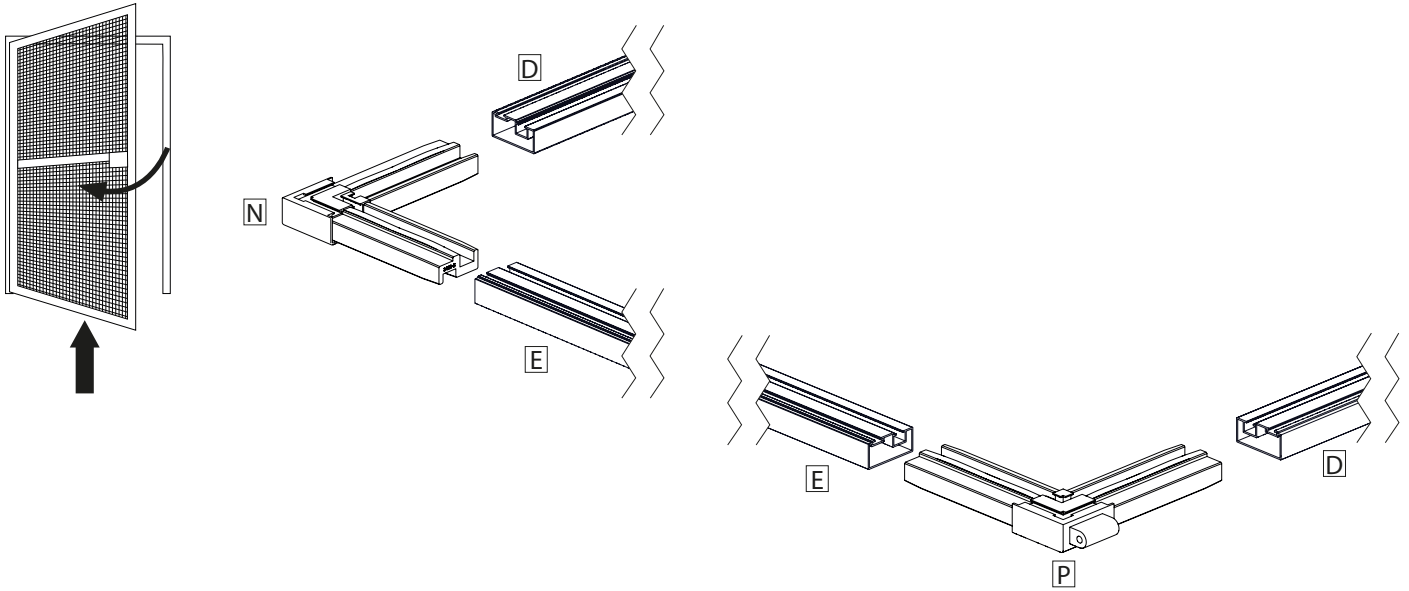

4

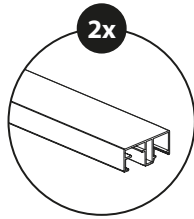

2x

G 01419-0002
500 mm

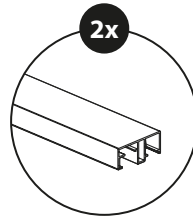

2x

H 01419-0002
500 mm

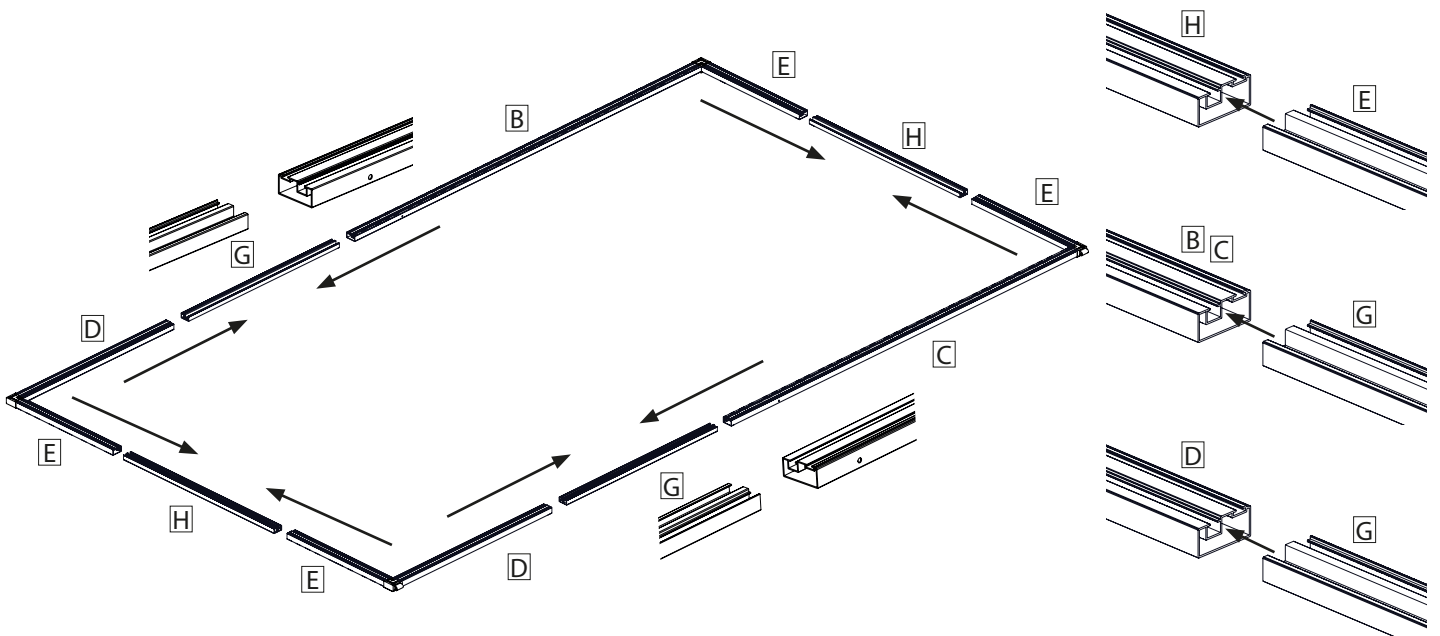

5

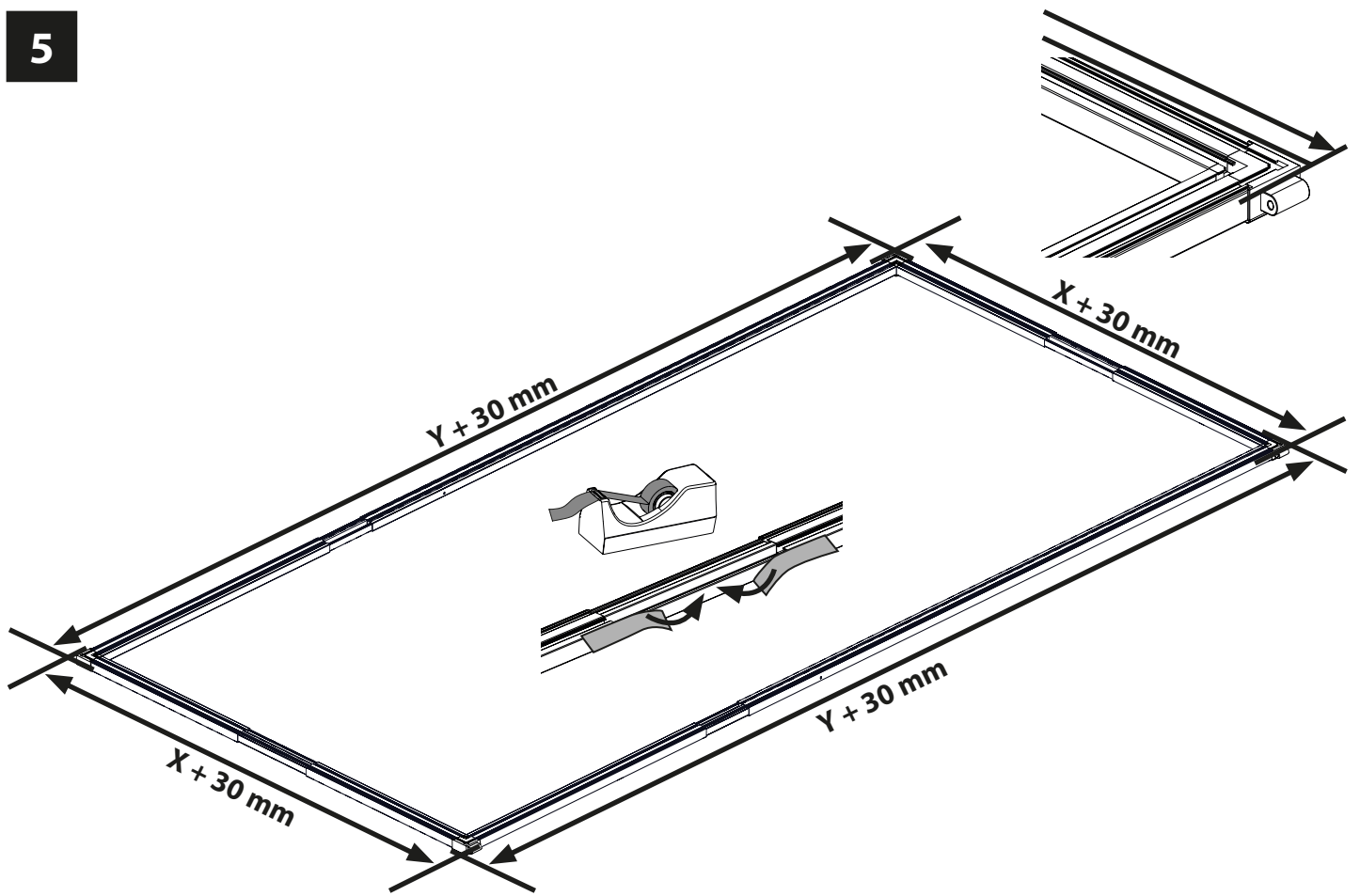

6

① = _____ cm

② = _____ cm

③ = _____ cm

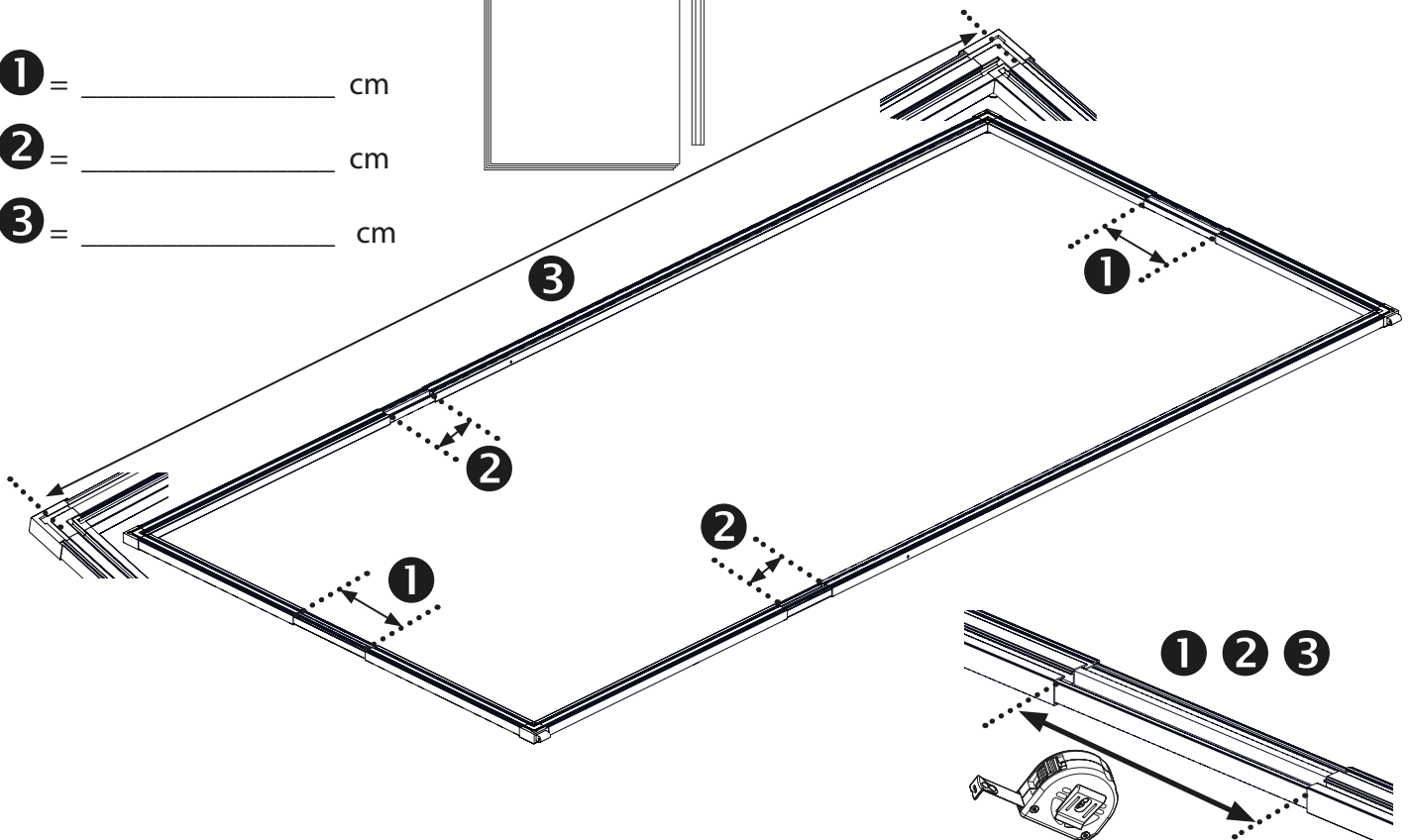
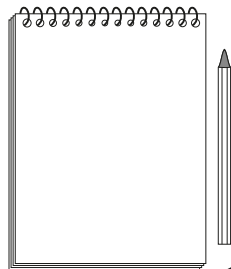

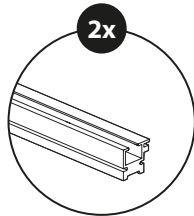
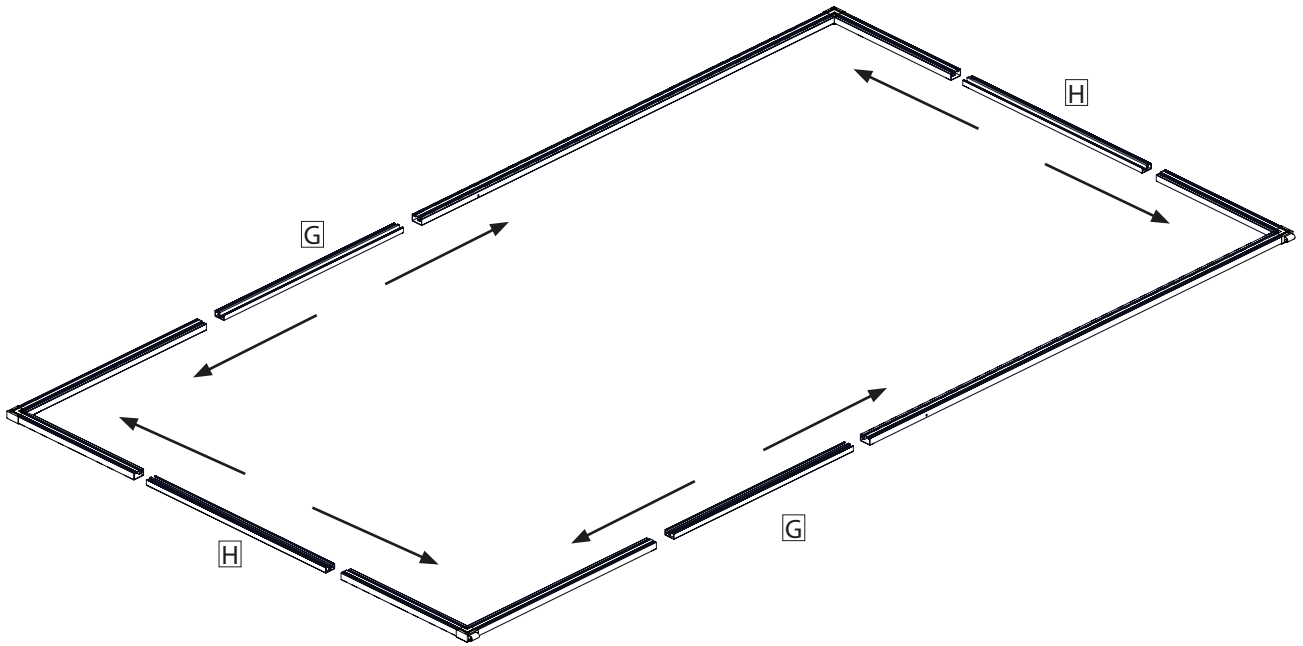

L 01419-0012
294 mm

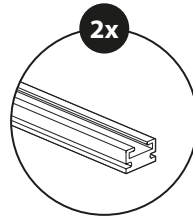

M 01419-0013
294 mm



6



1

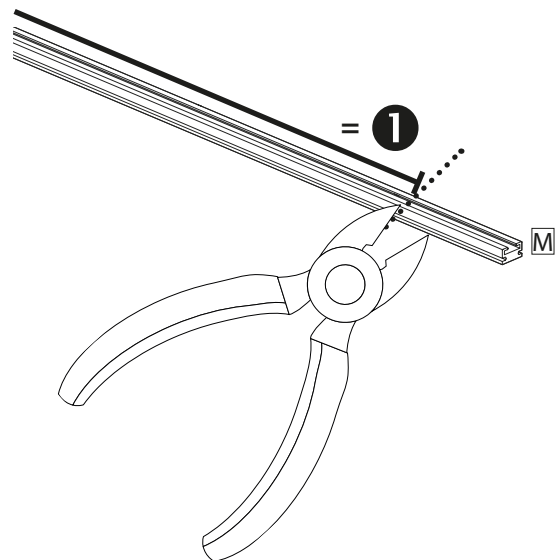
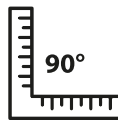
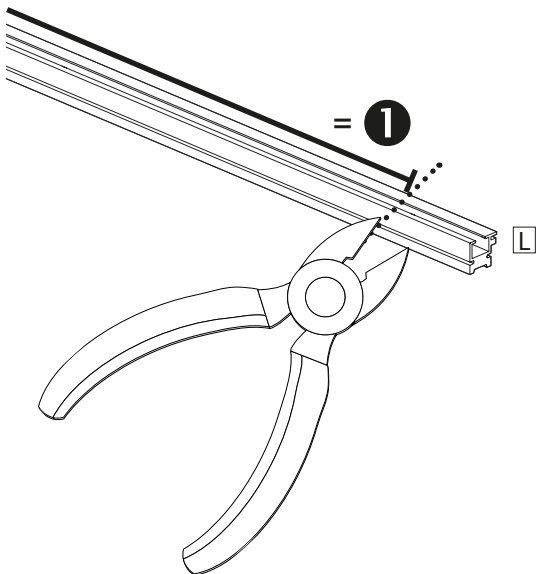

9

2x

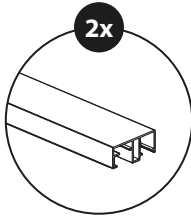

H 01419-0002
500 mm

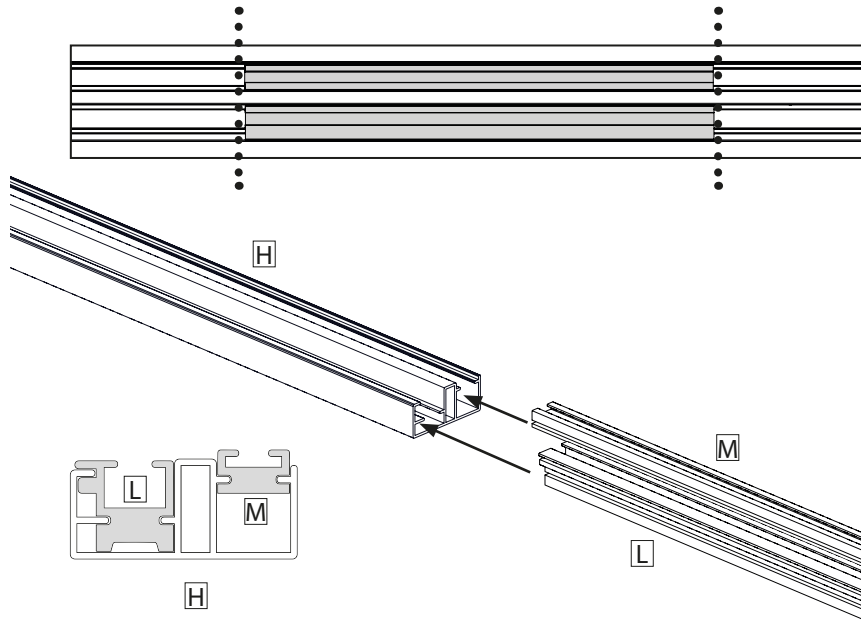

10

2x

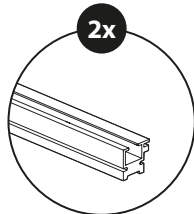

L 01419-0012
396 mm

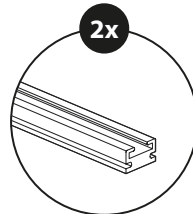

M 01419-0013
396 mm



6



2

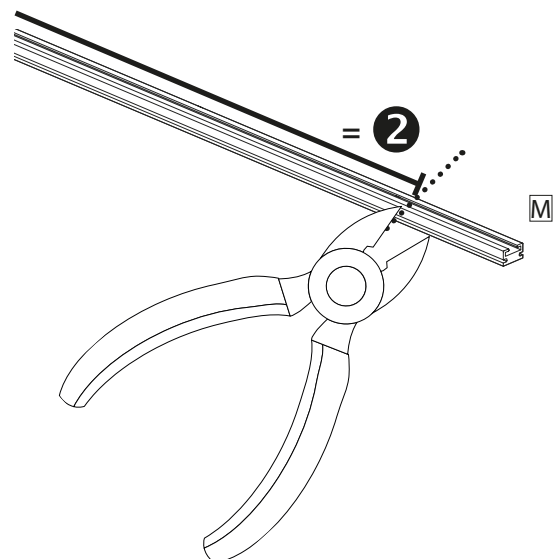
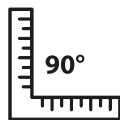
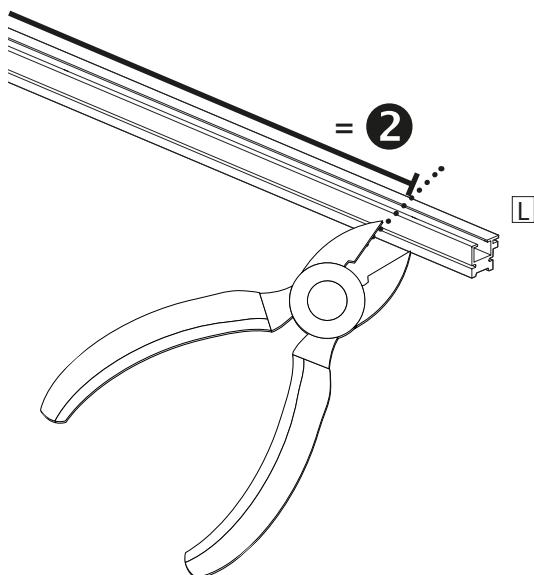

13 2x

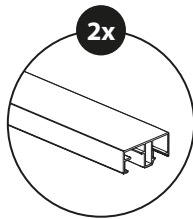

G 01419-0002
500 mm

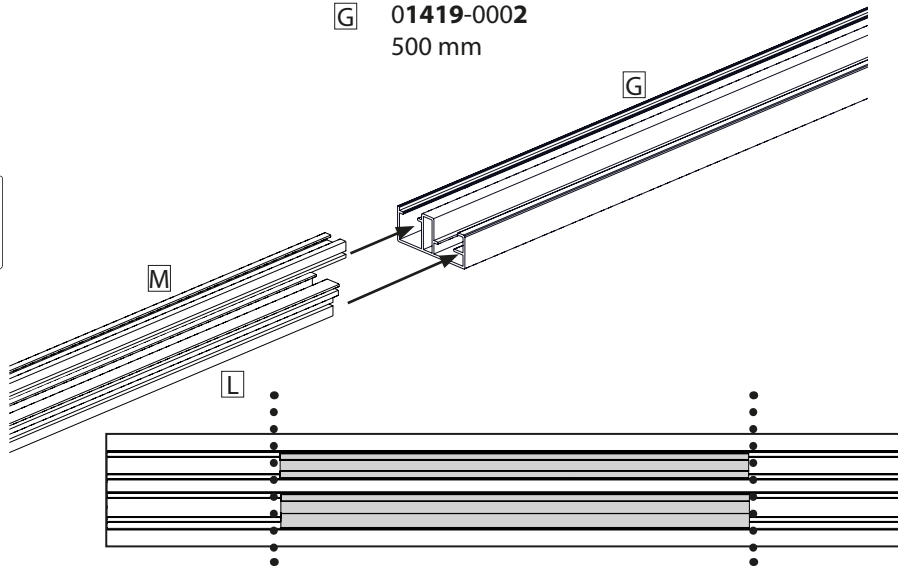
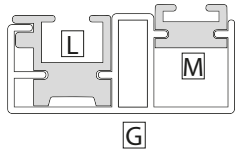

14



A B C D



15 – 18

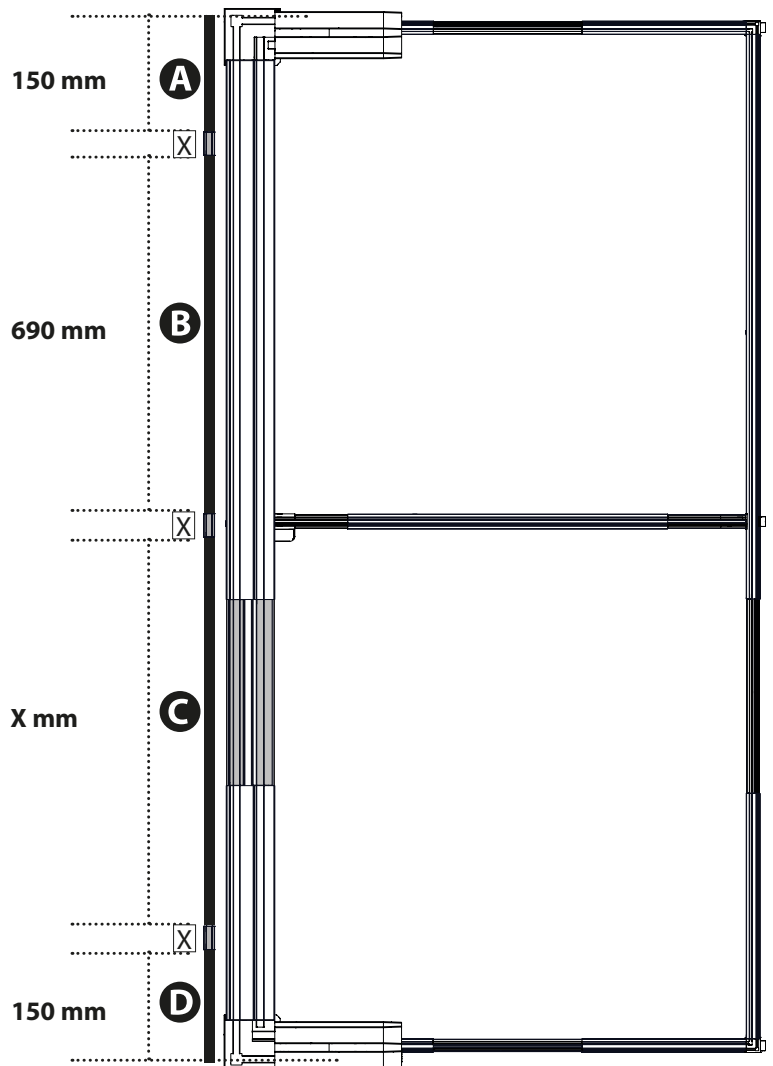
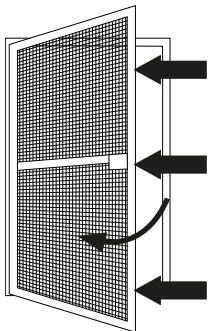

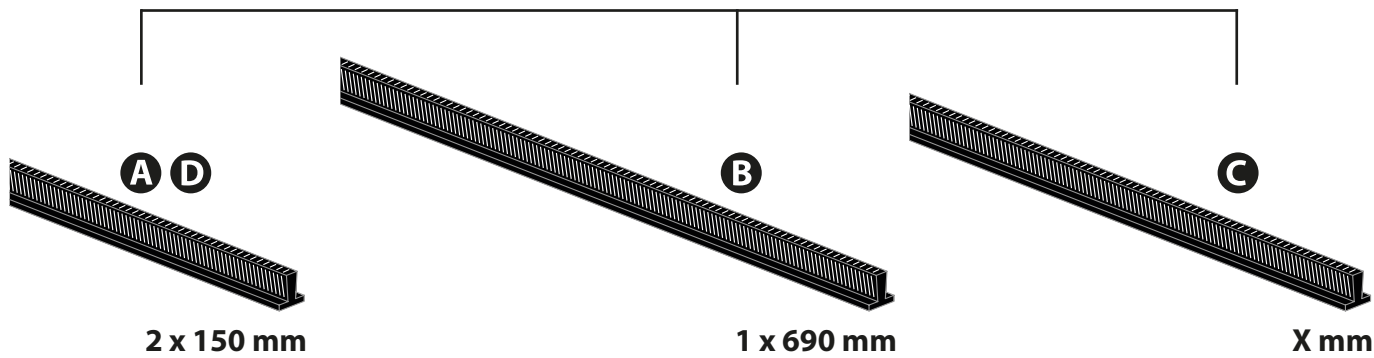
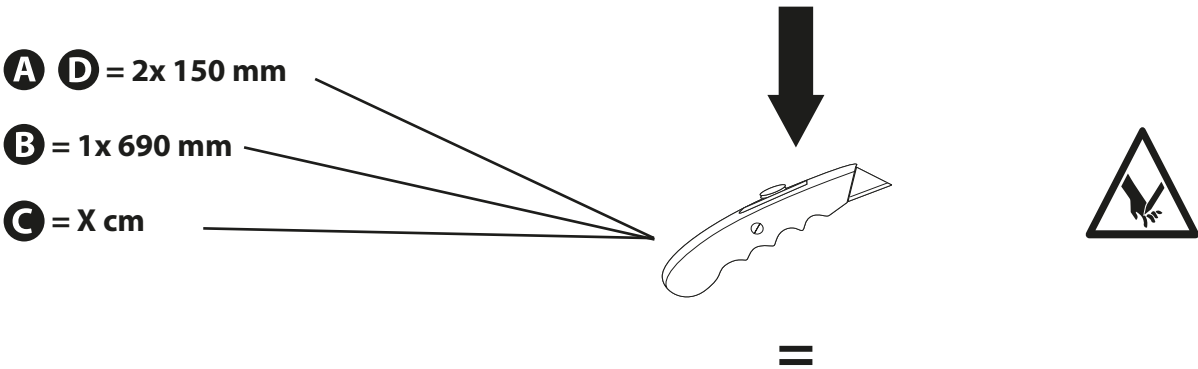
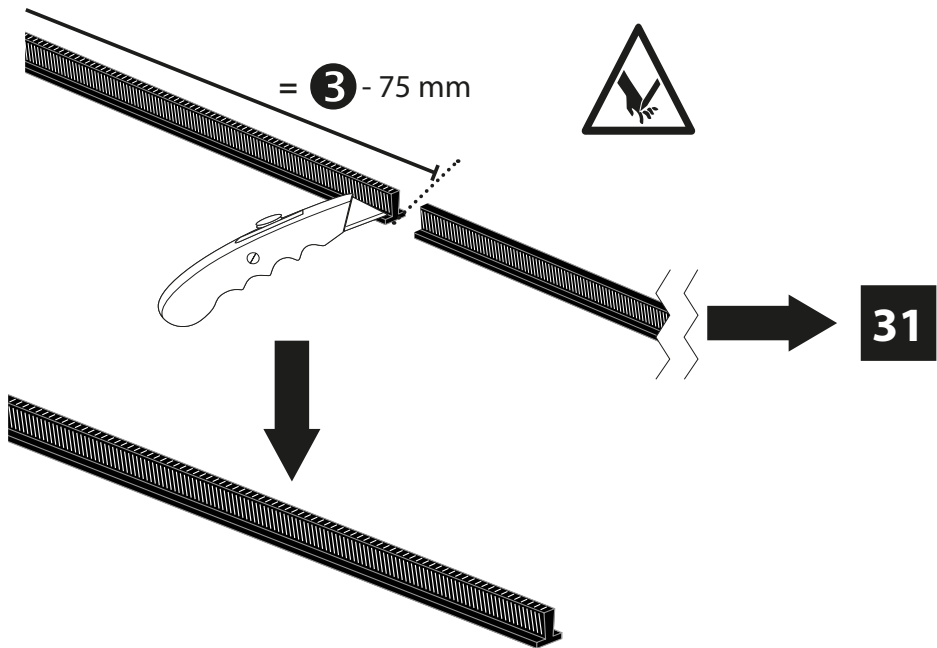
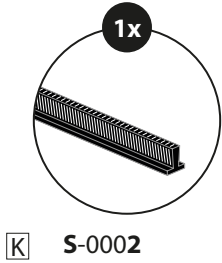

16

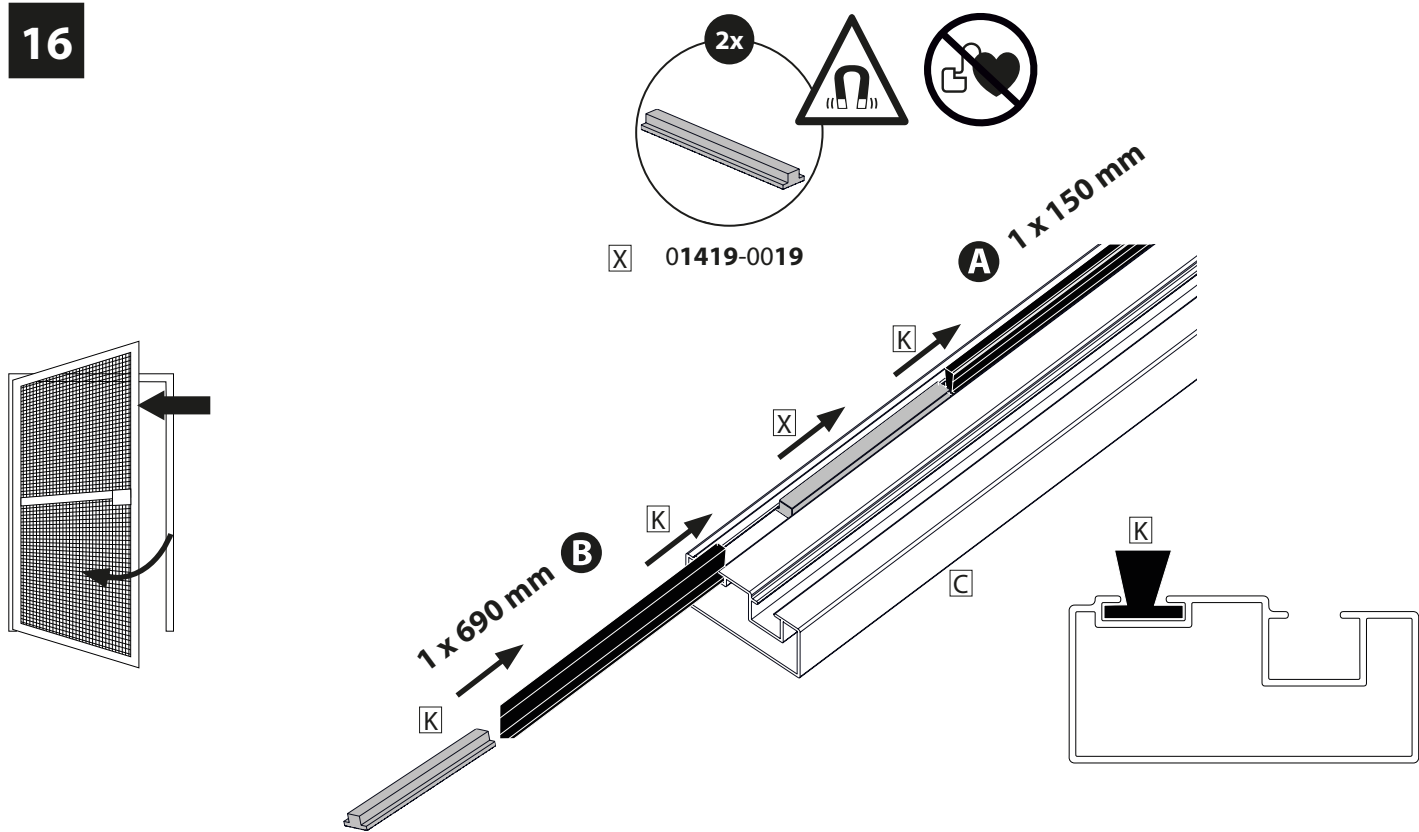

17

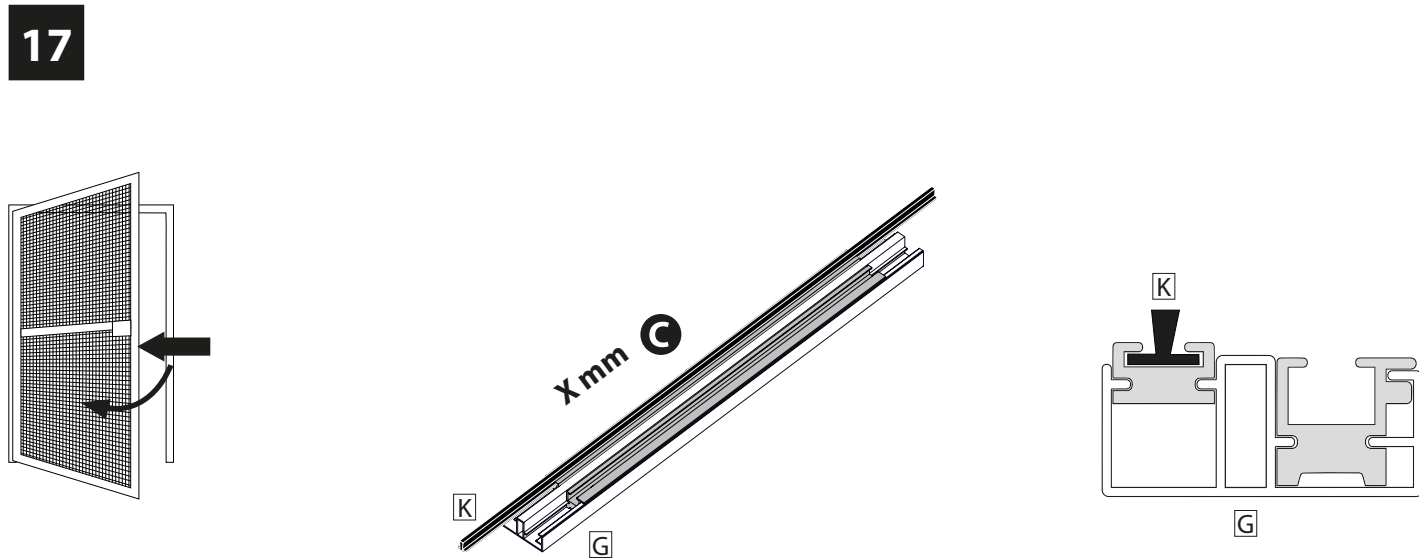

18

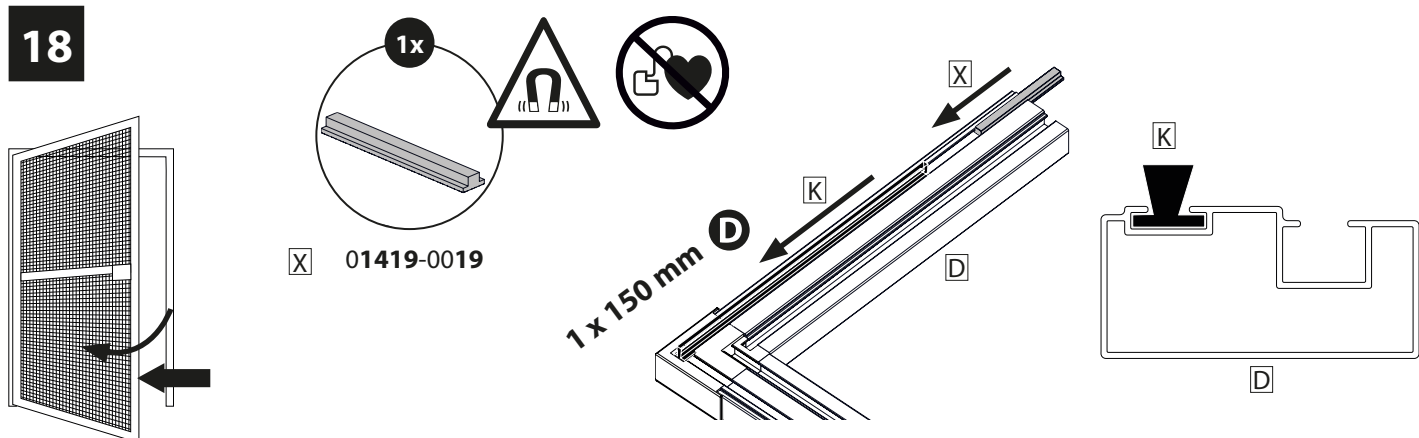

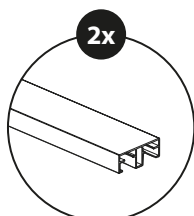
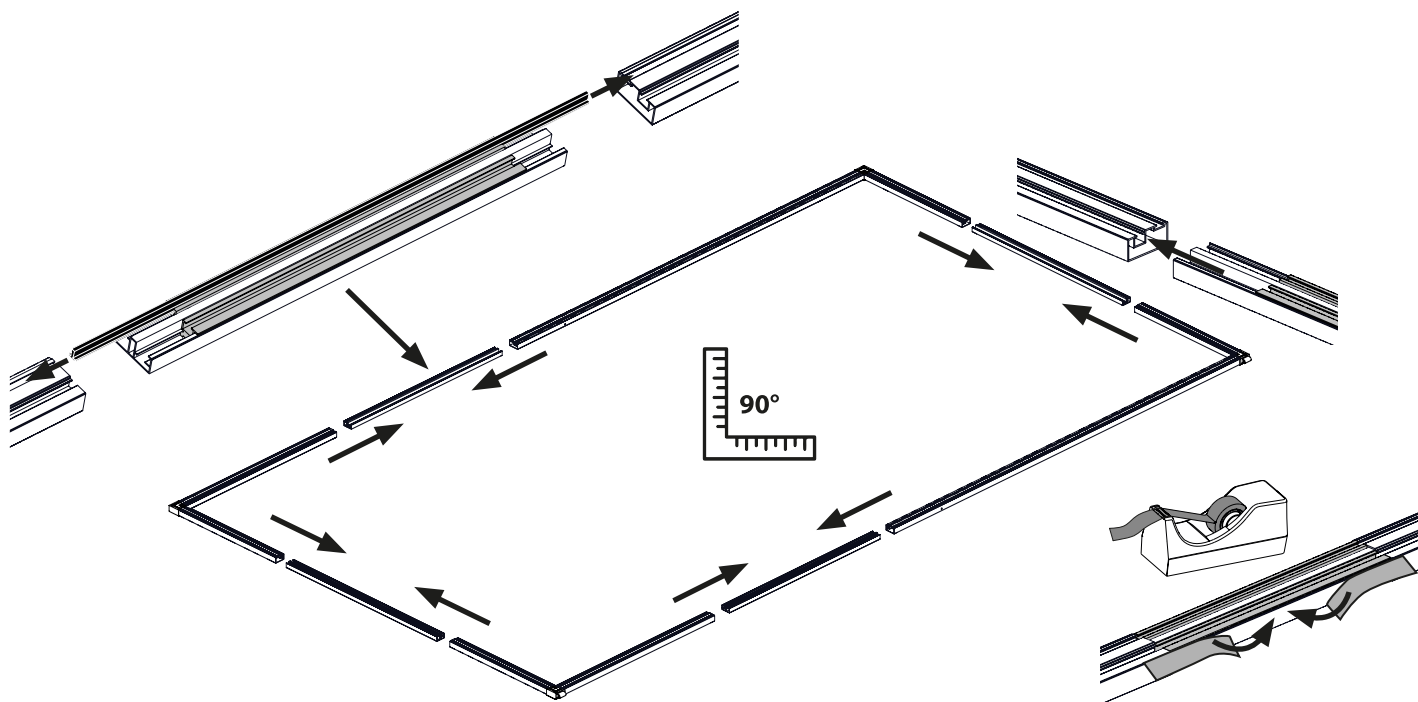

I 01419-0003-00
318 mm

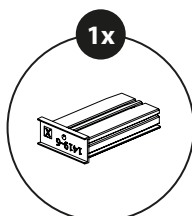

Q 01419-0006

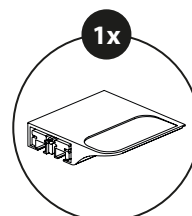

R 01419-0007

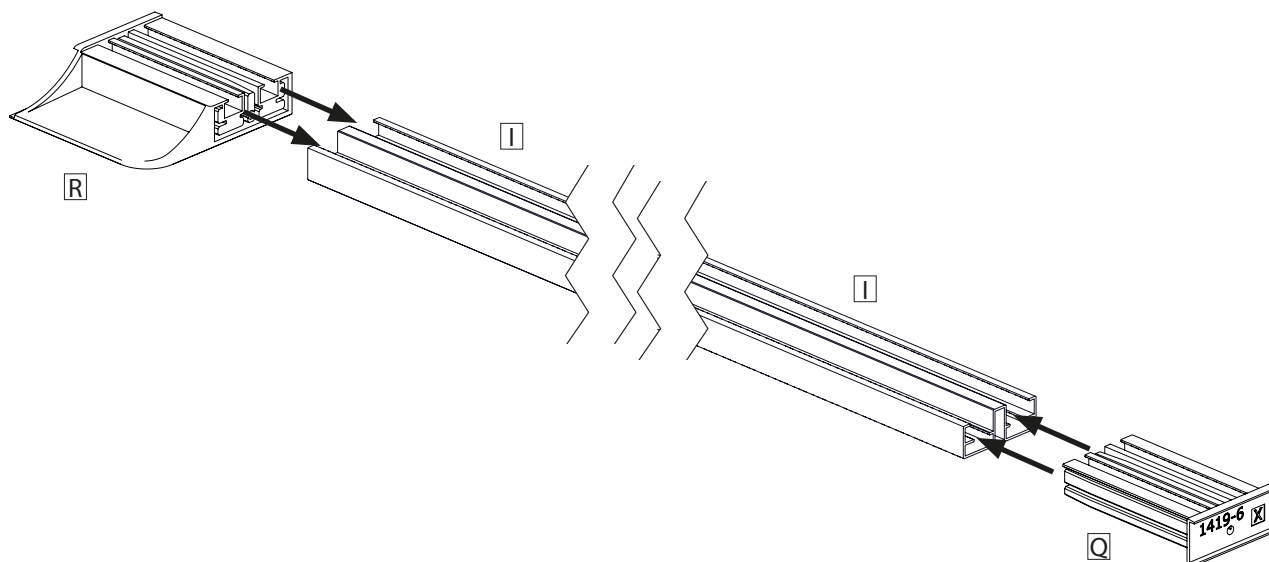

21

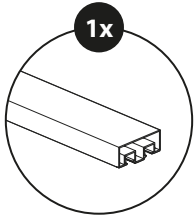

F 01419-0004
633 mm

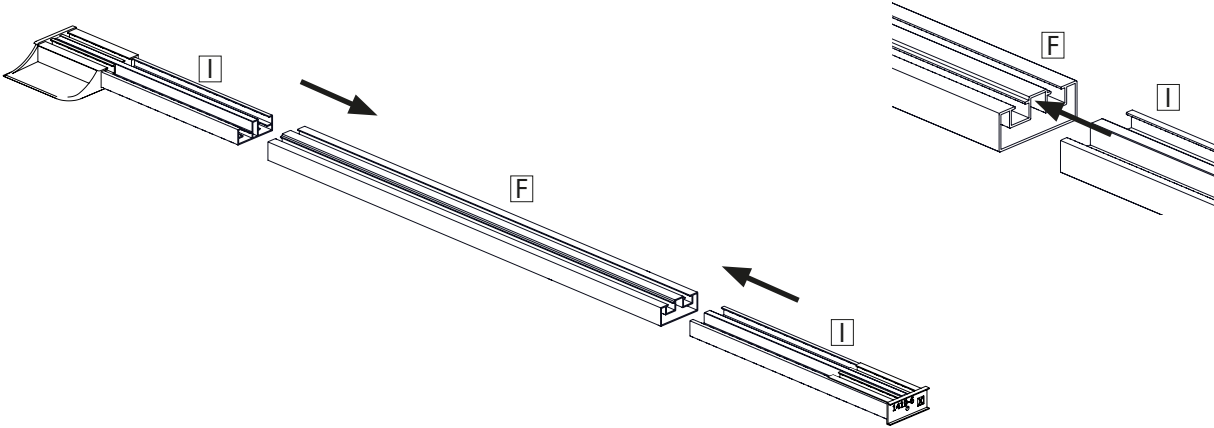

22

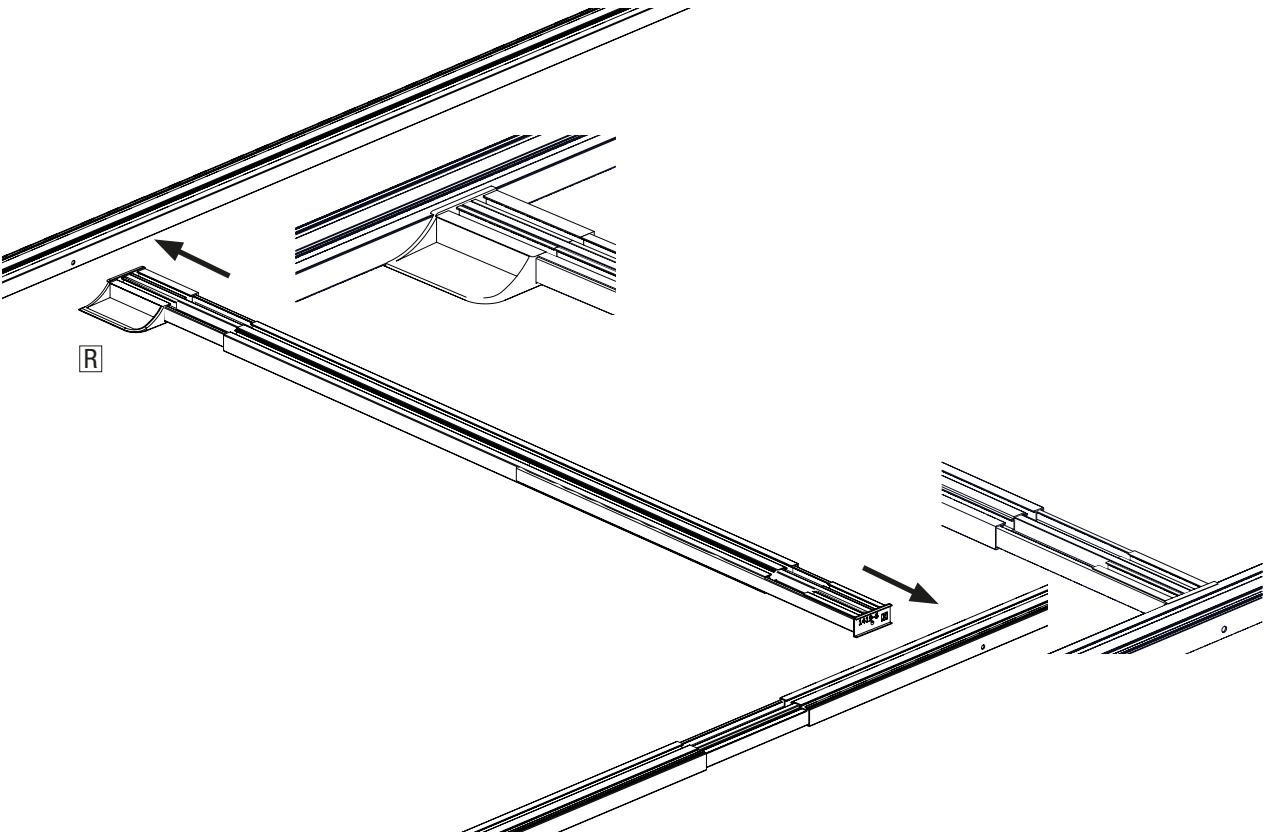

23

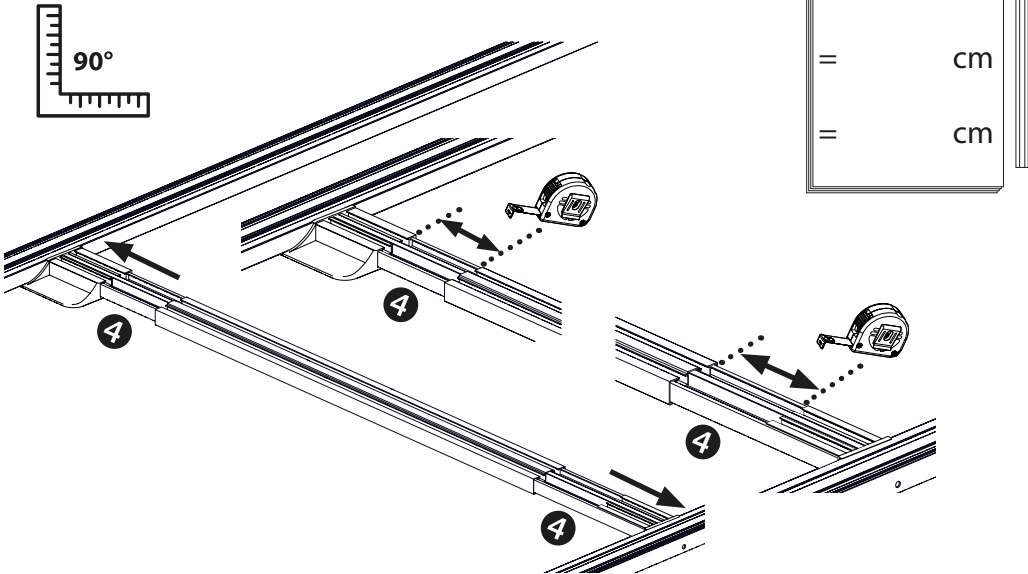
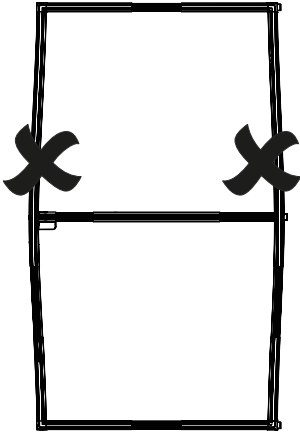

24

4x

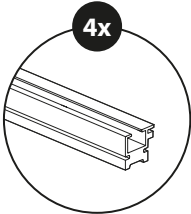

L 01419-0012
104 mm

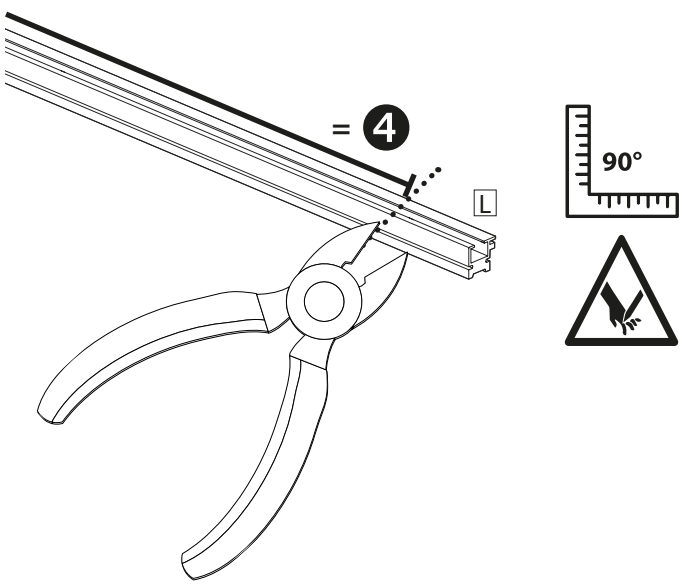

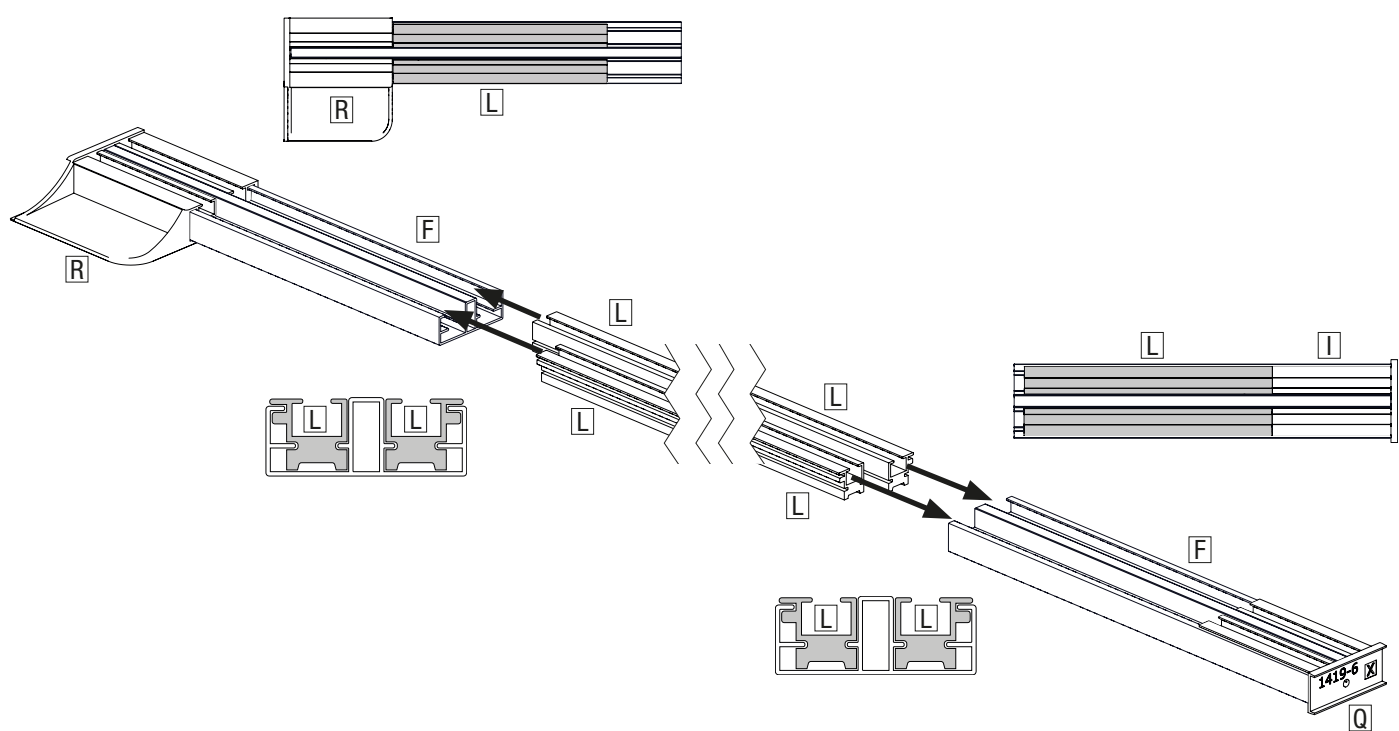
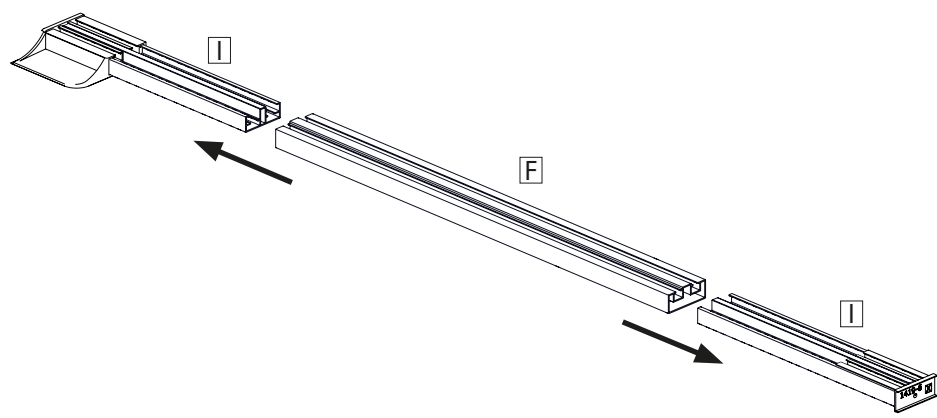

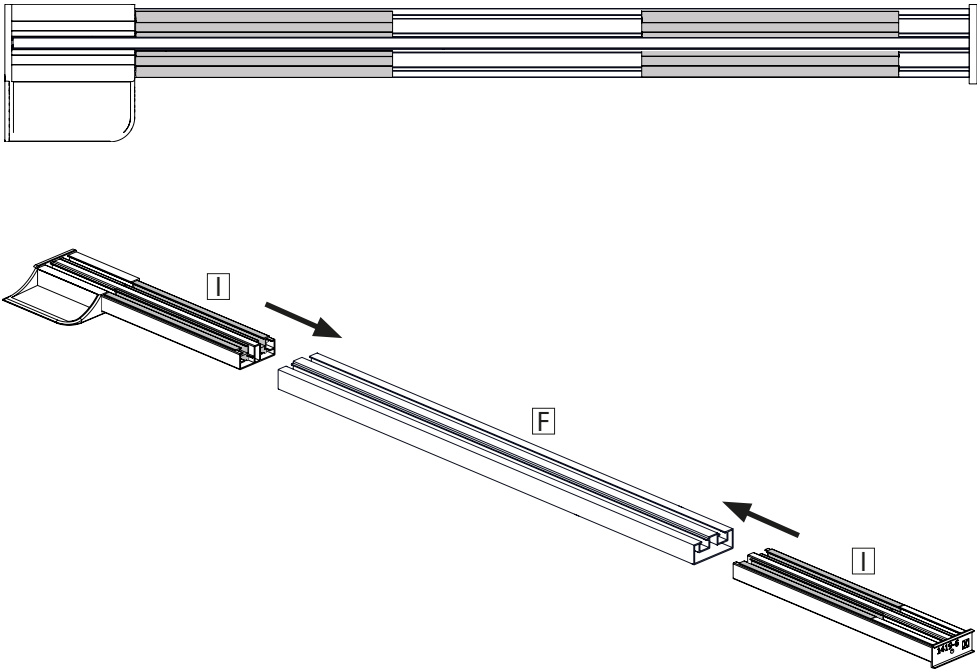

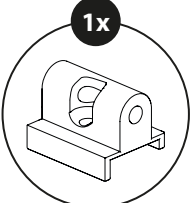
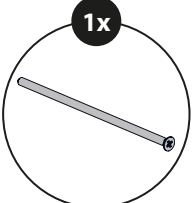
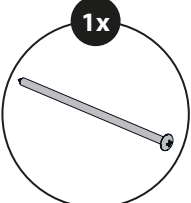
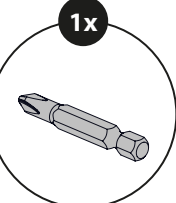
- | | | | |
|--|---|--|---|
| 
S 01419-0010 | 
D1 S-0132 | 
E1 S-0131 | 
H1 W-0002 |
|--|---|--|---|

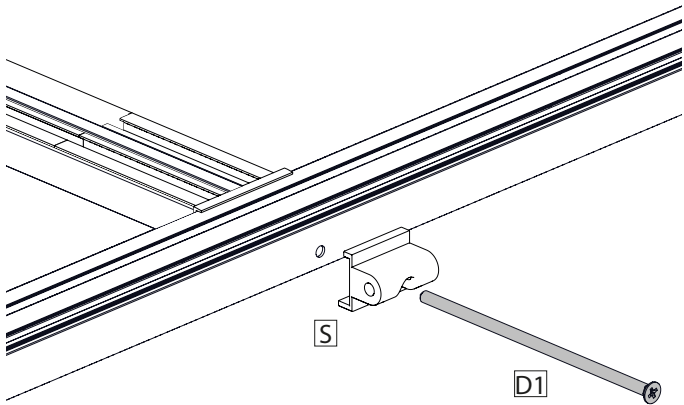
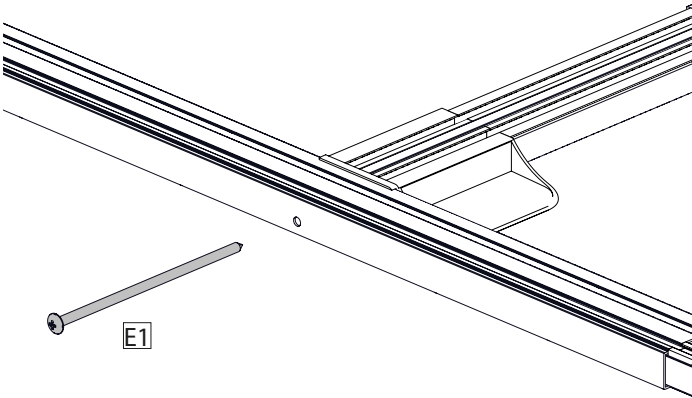

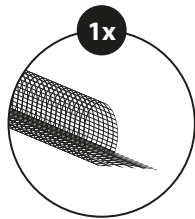

A S-0097

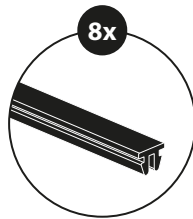

J S-0017
2x 1150 mm
2x 910 mm
2x 945 mm
2x 970 mm

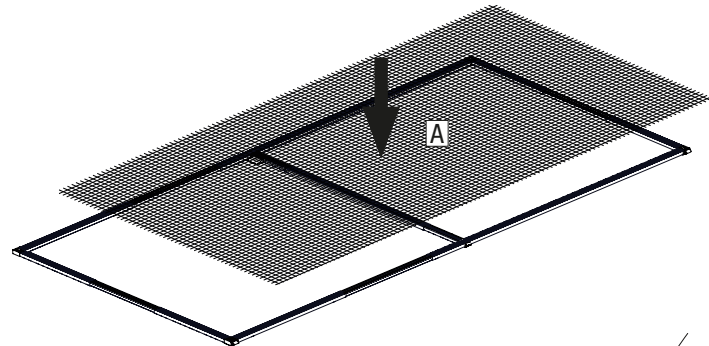

- ① 1150 mm 2x
- ② 910 mm 2x
- ③ 945 mm 2x
- ④ 970 mm 2x

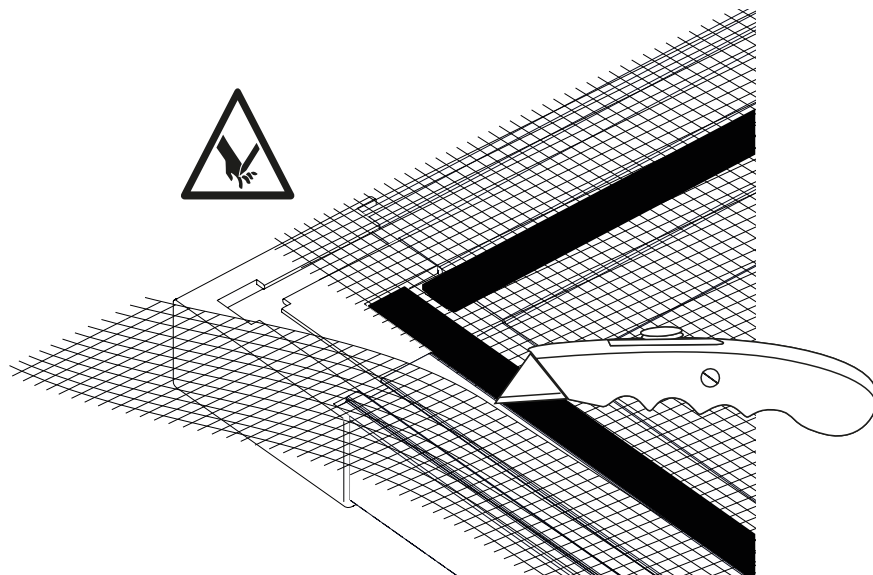
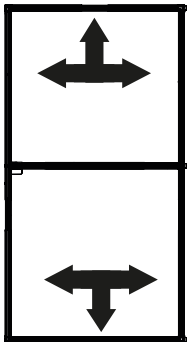
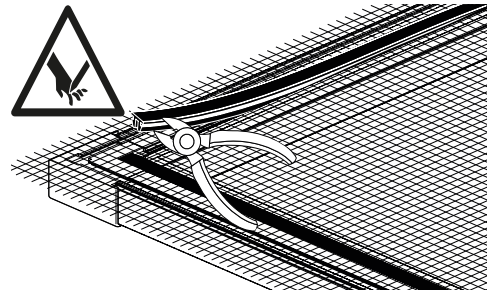
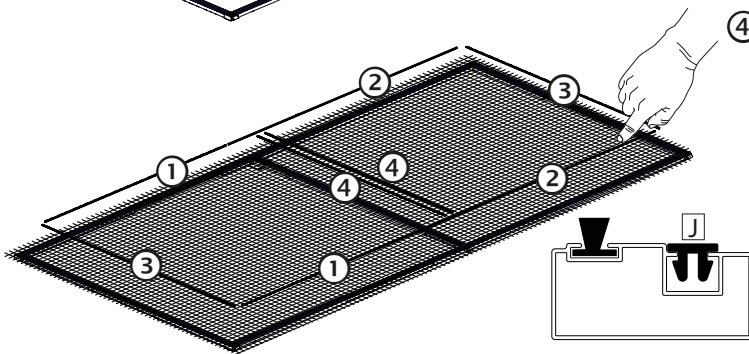

31

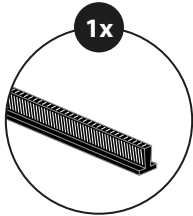
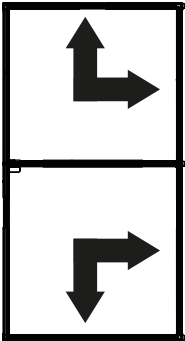

[K] S-0002

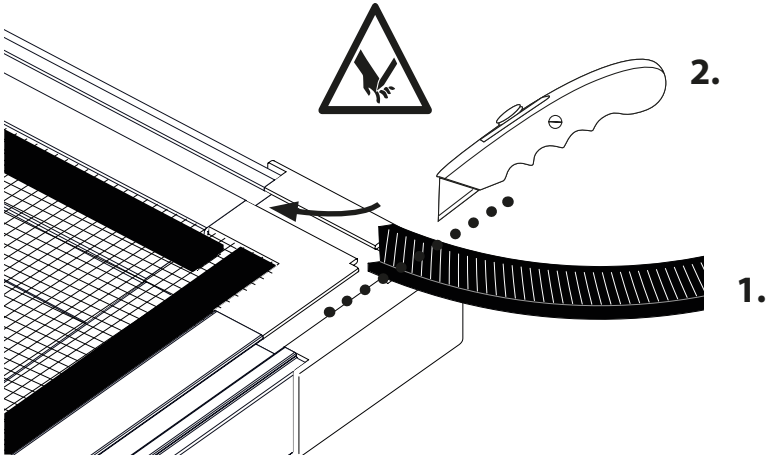

32

4x

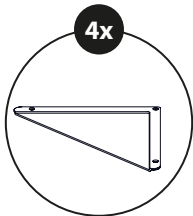
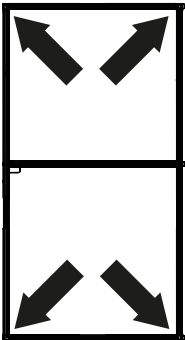

[C1] 01419-0029

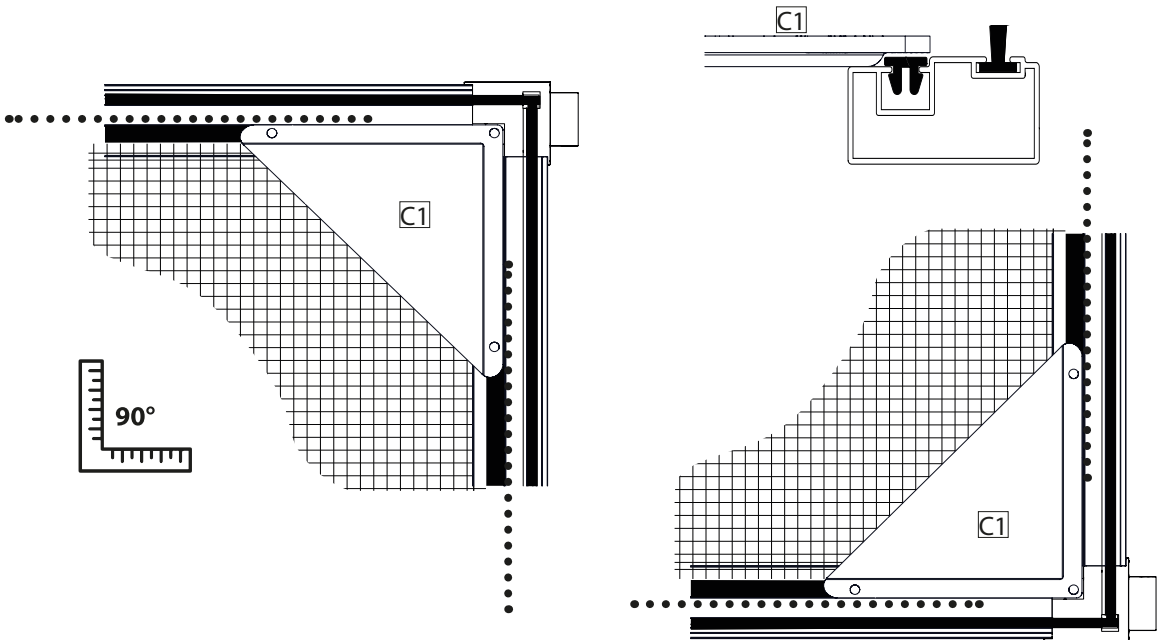

33 4x

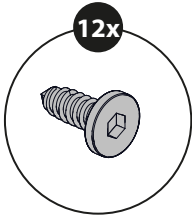

G1 S-0135

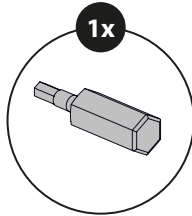

II1 W-0031

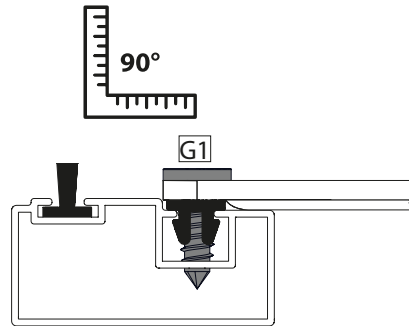
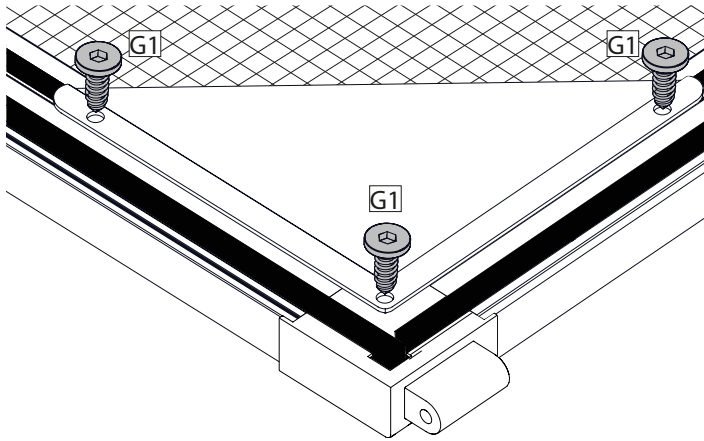

34

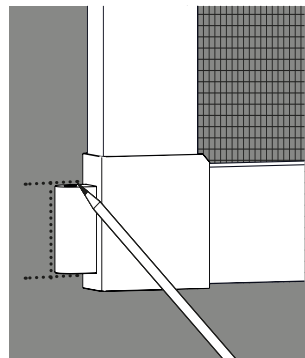
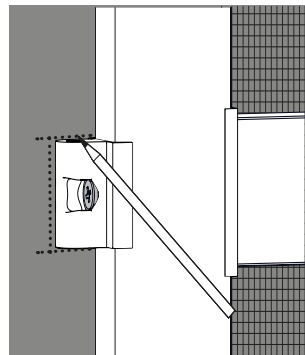
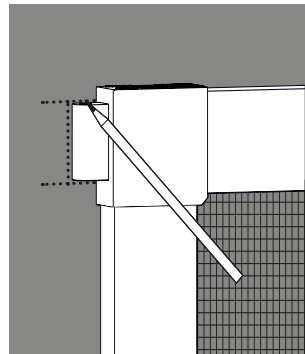
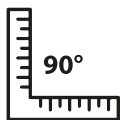
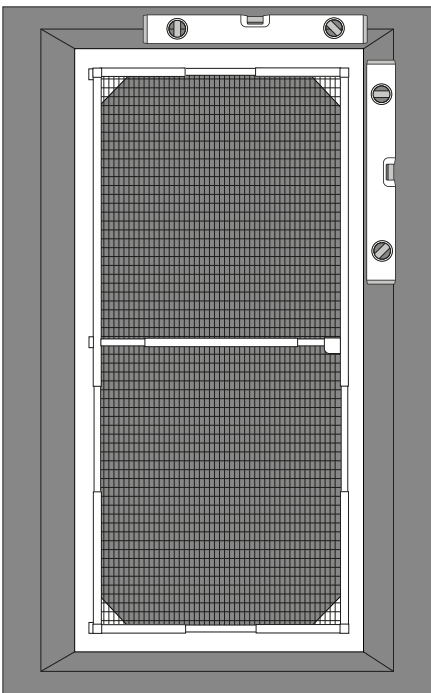

35

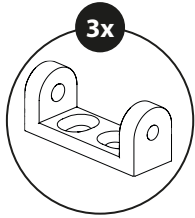

T 01419-0018

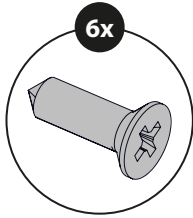

F1 N-0002

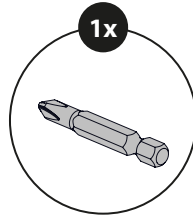

H1 W-0002

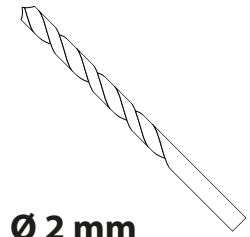

Ø 2 mm

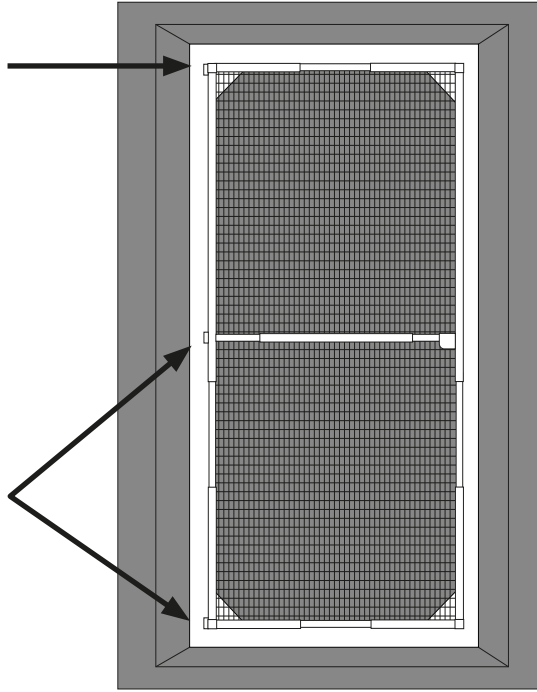
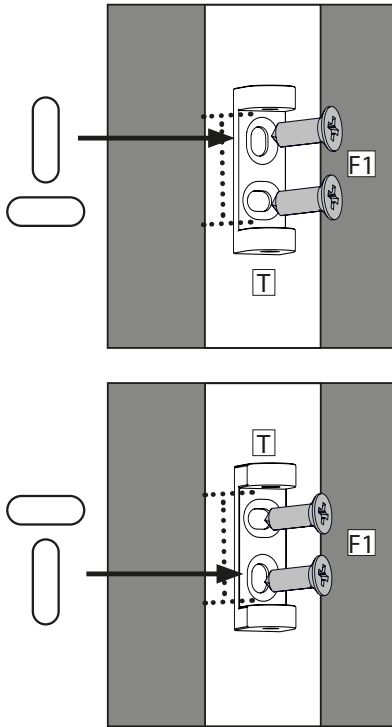

36

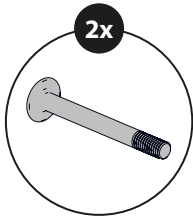

U 01419-0025

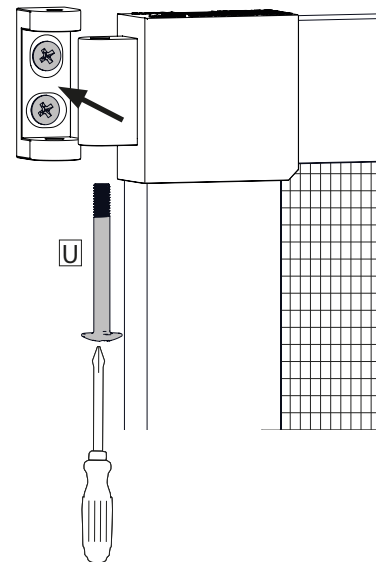
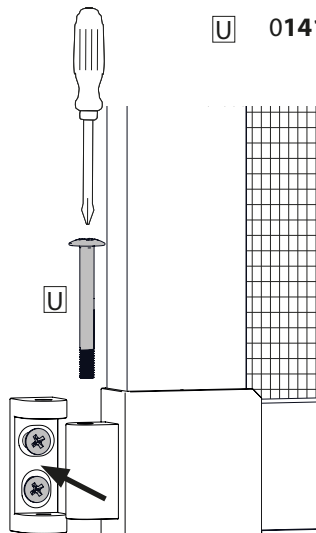
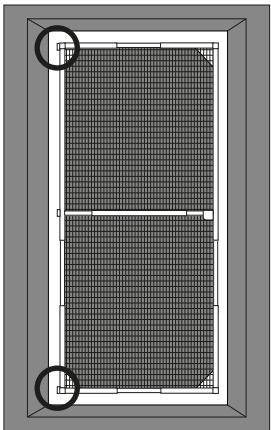

37

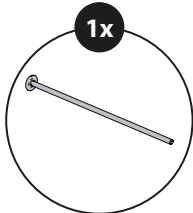

V 01419-0026

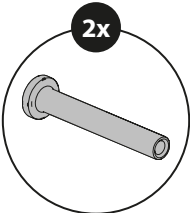

W 01419-0028

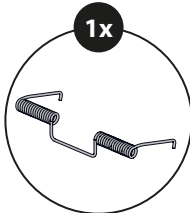

B1 01419-0027

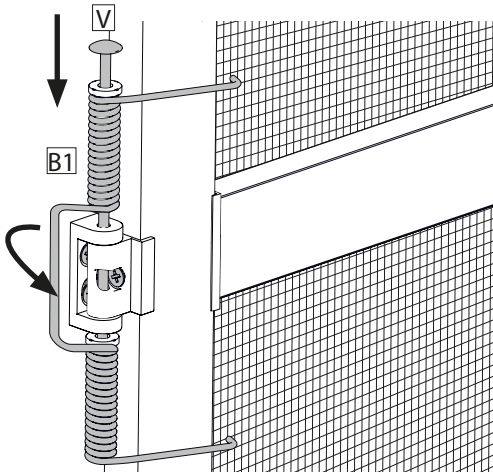
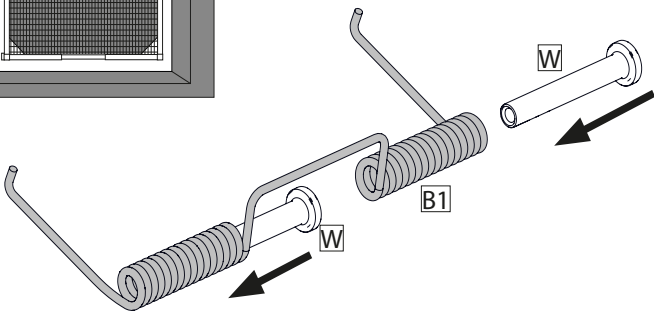
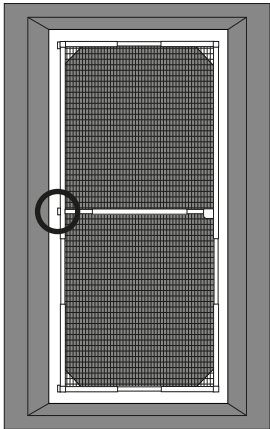

38 3x

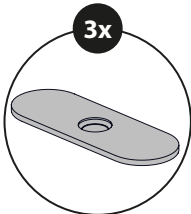

Z 00014-0027

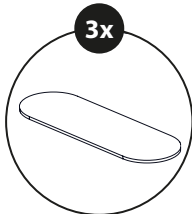

A1 00014-0045

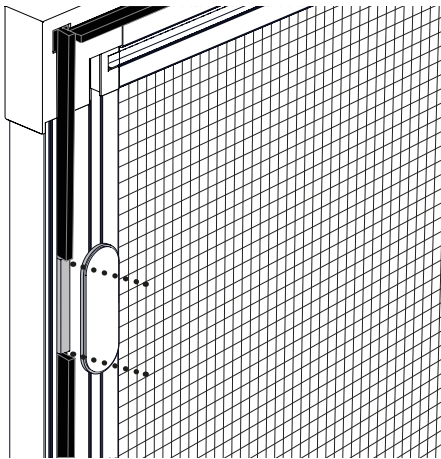
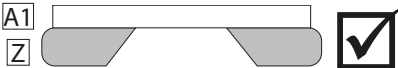
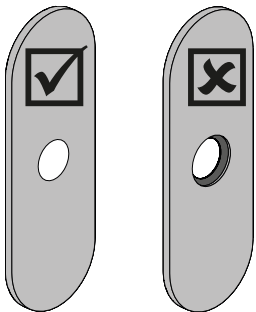
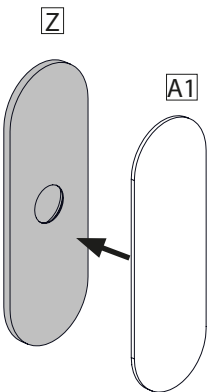

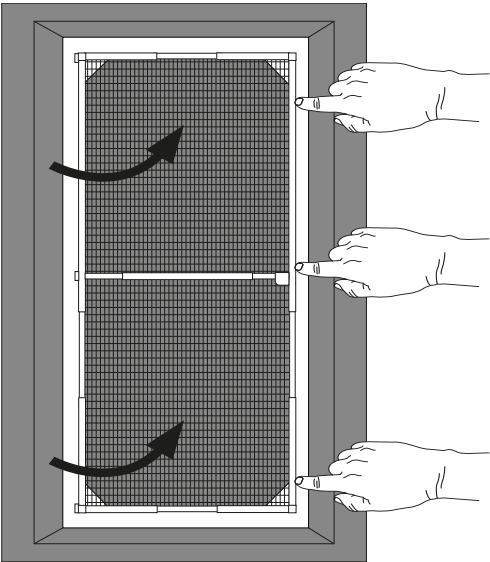

3x

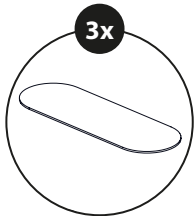

Y 00014-0044

3x

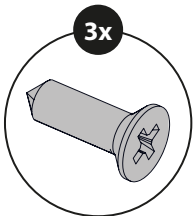

F1 N-0002

1x

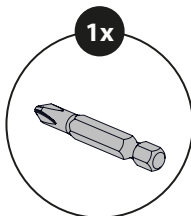

H1 W-0002

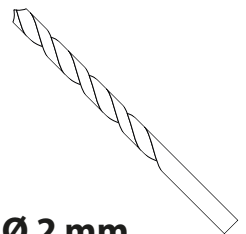

Ø 2 mm

